



भारतीय रिज़र्व बैंक / Reserve Bank of India  
संपदा विभाग / Estate Department  
चंडीगढ़ / Chandigarh

**ई-निविदा सूचना**

**भारतीय रिज़र्व बैंक, सेक्टर-17ए, चंडीगढ़ के मुख्य कार्यालय भवन में नई एसबीएस (SBS) मशीनों की स्थापना के लिए नकदी क्षेत्र के नवीनीकरण का कार्य**

भारतीय रिज़र्व बैंक, सेक्टर-17ए, चंडीगढ़ के मुख्य कार्यालय भवन में नई एसबीएस (SBS) मशीनों की स्थापना के लिए नकदी क्षेत्र के नवीनीकरण के कार्य के लिए भारतीय रिज़र्व बैंक, चंडीगढ़, पात्र और इच्छुक फर्मों से ई-निविदाएं आमंत्रित करता है। कार्य की अनुमानित लागत ₹37.46 लाख मात्र (जी.एस.टी. सहित) है।

2. यह एक सीमित ई-निविदा है। केवल वे फर्म जो संपदा विभाग, भारतीय रिज़र्व बैंक, चंडीगढ़ में Civil Repair Works (Trade No. 2) एवं Civil Interior and Renovation works (Trade No. 3) में ₹25 लाख से अधिक के कार्यों को करने के लिए श्रेणी V में सूचीबद्ध हैं, ई-निविदा प्रक्रिया में भाग ले सकेंगी। ई-निविदा दस्तावेज़ बैंक की वेबसाइट [www.rbi.org.in](http://www.rbi.org.in) पर डाउनलोड के लिए उपलब्ध है।

3. ई-निविदा दो भागों में ऑनलाइन प्रस्तुत की जाएगी। ई-निविदा के भाग-I में प्रस्तावित कार्य के लिए बैंक की मानक तकनीकी और वाणिज्यिक शर्तें होंगी, जिन पर निविदाकर्ता को सहमत होना होगा। ई-निविदा के भाग-II में बैंक की मात्राओं की अनुसूची निर्धारित की गयी है और निविदाकर्ता द्वारा मूल्य बोली ऑनलाइन प्रस्तुत की जाएगी।

4. पात्रता मानदंड को पूरा करने वाली फर्मों को कार्य के आवंटन के लिए विचार किए जाने हेतु 06 सितंबर 2024 को पूर्वाह्न 11:00 बजे तक या उससे पहले सभी आवश्यक दस्तावेजों को <https://www.mstcecommerce.com/eprocn> पर अपलोड करना होगा।

5. ई-निविदा के भाग-I को 06 सितंबर 2024 को अपराह्न 03:00 बजे MSTC Portal पर खोला जायेगा। ई-निविदा की समय-सारणी निम्न अनुसार है:

क	ई-निविदा सं.	RBI/Chandigarh Regional Office/Estate/9/24-25/ET/281
ख	निविदा प्रणाली	ई-प्रापण प्रणाली (ऑनलाइन <a href="https://www.mstcecommerce.com/eprocn">https://www.mstcecommerce.com/eprocn</a> पर भाग-I तकनीकी-वाणिज्यिक बोली तथा भाग-II मूल्य बोली)
ग	अनुमानित लागत	₹37.46 लाख मात्र (रुपए सैंतीस लाख छियालीस हजार मात्र) (जी. एस.टी. सहित)
घ	ई-निविदा दस्तावेज़ बैंक की वेबसाइट से डाउनलोड करने की प्रारम्भिक तिथि	06 अगस्त 2024 को साँय 05:00 बजे से

ड	<a href="https://www.mstcecommerce.com/eprocn">https://www.mstcecommerce.com/eprocn</a> पर ई-निविदा (ऑनलाइट तकनीकी-वाणिज्यिक बोली और मूल्य बोली) प्रारंभ होने की तारीख	06 अगस्त 2024 को साँय 05:00 बजे से
च	बोली पूर्व बैठक की तिथि एवं समय	27 अगस्त 2024 को पूर्वाह्न 11:00 बजे स्थान: संपदा विभाग, तृतीय तल, मुख्य कार्यालय भवन, भारतीय रिज़र्व बैंक, सेंट्रल विस्टा, सेक्टर-17, चंडीगढ़
छ	बयाना राशि (केवल NEFT के माध्यम से)	₹74,920/- (रुपए चौहत्तर हजार नौ सौ बीस मात्र) लाभार्थी का नाम- भारतीय रिज़र्व बैंक IFSC Code: RBIS0CGPA01 (पंचवा तथा दसवां अंक शून्य है) खाता सं.: 186003001
ज	बयाना राशि जमा करने की अंतिम तिथि	05 सितंबर 2024 तक
झ	ई-निविदा (तकनीकी-वाणिज्यिक बोली एवं मूल्य बोली) बंद होने की तिथि	06 सितंबर 2024 को पूर्वाह्न 11:00 बजे तक
ञ	ई-निविदा का भाग I (अर्थात तकनीकी-वाणिज्यिक बोली) खोलने की तारीख	06 सितंबर 2024 को अपराह्न 03:00 बजे यदि बोलीदाताओं द्वारा कोई विचलन प्रस्तुत नहीं किया गया तो भाग II उसी दिन खोला जाएगा। अन्यथा भाग II किसी अन्य तिथि पर खोला जाएगा जिसकी सूचना बोलीदाताओं को ईमेल के माध्यम से दी जाएगी।
ट	अंतरण फीस	अंतरण फीस का भुगतान एमएसटीसी भुगतान गेटवे / एनईएफटी माध्यम से एमएसटीसी लिमिटेड के पक्ष में किया जाएगा।

बैंक न्यूनतम निविदा को स्वीकार करने के लिए बाध्य नहीं है और किसी भी निविदा में पूर्ण या आंशिक रूप से स्वीकार करने का अधिकार सुरक्षित रखता है। बैंक बिना किसी कारण बताए सभी निविदाओं को अस्वीकार करने का अधिकार भी सुरक्षित रखता है।

कृते/-  
क्षेत्रीय निदेशक  
भारतीय रिज़र्व बैंक, चंडीगढ़



Reserve Bank of India  
Estate Department  
Chandigarh

भारतीय रिज़र्व बैंक, सेक्टर-17ए चंडीगढ़ के मुख्य कार्यालय भवन में नई एसबीएस (SBS) मशीनों की  
स्थापना के लिए नकदी क्षेत्र के नवीनीकरण के कार्य  
हेतु ई-निविदा

**Tender for  
Renovation of Cash Area for Installation of New SBS Machines at Main Office Building  
of Reserve Bank of India, Sector-17A, Chandigarh**

**RBI/Chandigarh Regional Office/Estate/9/24-25/ET/281**

**भाग-I (टेक्नो-कमर्शियल बोली)  
Part-I (Techno-Commercial Bid)**

बोलीदाता का नाम : .....

पता: .....

दूरभाष सं: .....

ईमेल:- .....

बोली पूर्व बैठक का समय एवं स्थान	27 अगस्त 2024 पूर्वाह्न 11:00 बजे <b>स्थान:</b> संपदा विभाग, तृतीय तल, मुख्य कार्यालय भवन, भारतीय रिज़र्व बैंक, सेंट्रल विस्टा, सेक्टर-17, चंडीगढ़
बोली प्रस्तुत करने की अंतिम तिथि:	06 सितंबर 2024 को पूर्वाह्न 11:00 बजे तक
निविदा का भाग I अर्थात तकनीकी-वाणिज्यिक बोली खोलने की तिथि:	06 सितंबर 2024 को अपराह्न 03:00 बजे

### **अस्वीकरण/ DISCLAIMER**

भारतीय रिज़र्व बैंक, सम्पदा विभाग, चंडीगढ़ ने इच्छुक पक्षों को कार्य की पृष्ठभूमि की जानकारी देने के लिए यह दस्तावेज़ तैयार किया है। जबकि भारतीय रिज़र्व बैंक ने इसमें निहित जानकारी को तैयार करने में उचित सावधानी बरती है और इसे सटीक मानते हैं, न तो भारतीय रिज़र्व बैंक और न ही इसके किसी भी प्राधिकरण या एजेंसियों और न ही उनके संबन्धित अधिकारियों, कर्मचारियों, एजेंटों या सलाहकारों में से कोई भी इस दस्तावेज़ में निहित जानकारी की पूर्णता या सटीकता के संबंध में कोई वारंटी या नुमाइंदगी, व्यक्त या निहित प्रदान करता है।

Reserve Bank of India, Estate Department, Chandigarh, has prepared this document to give background information on the work to the interested parties. While Reserve Bank of India has taken due care in the preparation of the information contained herein and believe it to be accurate, neither Reserve Bank of India nor any of its authorities or agencies nor any of their respective officers, employees, agents or advisors give any warranty or make any representations, express or implied as to the completeness or accuracy of the information contained in this document or any information which may be provided in association with it.

इस दस्तावेज़ का प्रयोजन सम्पूर्ण जानकारी प्रदान करने का नहीं है। इच्छुक पार्टियों से अपनी स्वयं की पूछताछ करना अपेक्षित है। इस ई-निविदा के प्रत्यर्थी को अपनी स्वयं की पूछताछ करने की आवश्यकता है और उन्हें केवल खाली ई-निविदा दस्तावेज़ों / फार्मों में निहित जानकारी पर भरोसा नहीं करना चाहिए। यदि उत्तरदाताओं द्वारा सम्यक उद्यम का पालन नहीं किया जाता है तो भारतीय रिज़र्व बैंक ज़िम्मेदार नहीं होगा।

The information is not intended to be exhaustive. Interested parties are required to make their own inquiries. Respondents to this tender are required to make their own inquiries and they should not rely solely on the information contained in the blank tender documents / forms. The Reserve Bank of India is not responsible if no due diligence is performed by the Respondents.

यह जानकारी इस आधार पर प्रदान की जाती है कि यह भारतीय रिज़र्व बैंक या इसके किसी भी प्राधिकरण या एजेंसियों या उनके संबन्धित अधिकारियों, कर्मचारियों, एजेंटों या सलाहकारों पर बाध्यकारी नहीं है।

The information is provided on the basis that it is non-binding on Reserve Bank of India or any of its authorities or agencies or any of their respective officers, employees, agents or advisors.

भारतीय रिज़र्व बैंक परियोजना के साथ आगे बढ़ने या परियोजना के विन्यास को बदलने, इस दस्तावेज़ में परिलक्षित समय सारिणी को बदलने या लागू होने वाली प्रक्रिया को बदलने का अधिकार सुरक्षित रखता है। यह रूचि व्यक्त करने वाले किसी भी पक्ष के साथ मामले पर आगे चर्चा करने से इनकार करने का अधिकार भी सुरक्षित रखता है। रूचि व्यक्त करने वाले व्यक्तियों या संस्थाओं को किसी भी प्रकार की लागत की प्रतिपूर्ति का भुगतान नहीं किया जाएगा।

Reserve Bank of India reserves the right not to proceed with the Project or to change the configuration of the Project, to alter the time table reflected in this document or to change the process or procedure to be applied. It also reserves the right to decline to discuss the matter further with any party expressing interest. No reimbursement of cost of any type will be paid to persons or entities expressing interest.

<b>Table of Contents</b>	
भाग-I (टेक्नो-कमर्शियल बोली) .....	1
अस्वीकरण .....	2
Table of Contents .....	3
ई-निविदा सूचना .....	4
E-Tender Notice .....	6
Form of Tender.....	8
Section I : Commercial Conditions .....	10
Section-II : Scope of Work .....	21
Section III: Technical Specification of the Work .....	24
Safety Code .....	49
Fire Safety Code .....	50
Annexure I: Important Instructions regarding e-tender.....	51
Annexure II- Draft Articles of Agreement .....	56
Annexure III- Proforma of Bank Guarantee for Performance Security Deposit.....	63
Annexure IV: Undertaking regarding declaration of debarment by public institution.....	66
Annexure V- Proforma for Indemnifying the Employer against Contract Labour Rules / Regulations .....	67
Annexure VI-Proforma for Indemnifying the Employer against Patent Rights .....	68
Part II: Unpriced Bill of Quantity.....	69



**भारतीय रिज़र्व बैंक / Reserve Bank of India**  
**संपदा विभाग / Estate Department**  
**चंडीगढ़ / Chandigarh**

### ई-निविदा सूचना

#### **भारतीय रिज़र्व बैंक, सेक्टर-17ए, चंडीगढ़ के मुख्य कार्यालय भवन में नई एसबीएस (SBS) मशीनों की स्थापना के लिए नकदी क्षेत्र के नवीनीकरण का कार्य**

भारतीय रिज़र्व बैंक, सेक्टर-17ए, चंडीगढ़ के मुख्य कार्यालय भवन में नई एसबीएस (SBS) मशीनों की स्थापना के लिए नकदी क्षेत्र के नवीनीकरण के कार्य के लिए भारतीय रिज़र्व बैंक, चंडीगढ़, पात्र और इच्छुक फर्मों से ई-निविदाएं आमंत्रित करता है। कार्य की अनुमानित लागत ₹37.46 लाख मात्र (जी॰एस॰टी॰ सहित) है।

2. यह एक सीमित ई-निविदा है। केवल वे फर्म जो संपदा विभाग, भारतीय रिज़र्व बैंक, चंडीगढ़ में Civil Repair Works (Trade No. 2) एवं Civil Interior and Renovation works (Trade No. 3) में ₹25 लाख से अधिक के कार्यों को करने के लिए श्रेणी V में सूचीबद्ध हैं, ई-निविदा प्रक्रिया में भाग ले सकेंगी। ई-निविदा दस्तावेज बैंक की वेबसाइट [www.rbi.org.in](http://www.rbi.org.in) पर डाउनलोड के लिए उपलब्ध है।

3. ई-निविदा दो भागों में ऑनलाइन प्रस्तुत की जाएगी। ई-निविदा के भाग- I में प्रस्तावित कार्य के लिए बैंक की मानक तकनीकी और वाणिज्यिक शर्तें होंगी, जिन पर निविदाकर्ता को सहमत होना होगा। ई-निविदा के भाग- II में बैंक की मात्राओं की अनुसूची निर्धारित की गयी है और निविदाकर्ता द्वारा मूल्य बोली ऑनलाइन प्रस्तुत की जाएगी।

4. पात्रता मानदंड को पूरा करने वाली फर्मों को कार्य के आवंटन के लिए विचार किए जाने हेतु 06 सितंबर 2024 को पूर्वाह्न 11:00 बजे तक या उससे पहले सभी आवश्यक दस्तावेजों को <https://www.mstcecommerce.com/eproc> पर अपलोड करना होगा।

5. ई-निविदा के भाग-I को 06 सितंबर 2024 को अपराह्न 03:00 बजे MSTC Portal पर खोला जायेगा। ई-निविदा की समय-सारणी निम्न अनुसार है:

क	ई-निविदा सं.	RBI/Chandigarh Regional Office/Estate/9/24-25/ET/281
ख	निविदा प्रणाली	ई-प्रापण प्रणाली (ऑनलाइन <a href="https://www.mstcecommerce.com/eproc">https://www.mstcecommerce.com/eproc</a> पर भाग-I तकनीकी-वाणिज्यिक बोली तथा भाग-II मूल्य बोली)
ग	अनुमानित लागत	₹37.46 लाख मात्र (रुपए सैंतीस लाख छियालीस हजार मात्र) (जी.एस.टी. सहित)
घ	ई-निविदा दस्तावेज़ बैंक की वेबसाइट से डाउनलोड करने की प्रारम्भिक तिथि	06 अगस्त 2024 को साँय 05:00 बजे से
ङ	<a href="https://www.mstcecommerce.com/eproc">https://www.mstcecommerce.com/eproc</a> पर ई-निविदा (ऑनलाइट	06 अगस्त 2024 को साँय 05:00 बजे से

	तकनीकी-वाणिज्यिक बोली और मूल्य बोली) प्रारंभ होने की तारीख	
च	बोली पूर्व बैठक की तिथि एवं समय	27 अगस्त 2024 को पूर्वाह्न 11:00 बजे स्थान: संपदा विभाग, तृतीय तल, मुख्य कार्यालय भवन, भारतीय रिज़र्व बैंक, सेंट्रल विस्टा, सेक्टर-17, चंडीगढ़
छ	बयाना राशि (केवल NEFT के माध्यम से)	₹74,920/- (रुपए चोहत्तर हजार नौ सौ बीस मात्र) लाभार्थी का नाम - भारतीय रिज़र्व बैंक IFSC Code: RBIS0CGPA01 (पंचवा तथा दसवां अंक शून्य है) खाता सं०: 186003001
ज	बयाना राशि जमा करने की अंतिम तिथि	05 सितंबर 2024 तक
झ	ई-निविदा (तकनीकी-वाणिज्यिक बोली एवं मूल्य बोली) बंद होने की तिथि	06 सितंबर 2024 को पूर्वाह्न 11:00 बजे तक
ञ	ई-निविदा का भाग I (अर्थात् तकनीकी-वाणिज्यिक बोली) खोलने की तारीख	06 सितंबर 2024 को अपराह्न 03:00 बजे यदि बोलीदाताओं द्वारा कोई विचलन प्रस्तुत नहीं किया गया तो भाग II उसी दिन खोला जाएगा। अन्यथा भाग II किसी अन्य तिथि पर खोला जाएगा जिसकी सूचना बोलीदाताओं को ईमेल के माध्यम से दी जाएगी।
ट	अंतरण फीस	अंतरण फीस का भुगतान एमएसटीसी भुगतान गेटवे / एनईएफटी माध्यम से एमएसटीसी लिमिटेड के पक्ष में किया जाएगा।

बैंक न्यूनतम निविदा को स्वीकार करने के लिए बाध्य नहीं है और किसी भी निविदा में पूर्ण या आंशिक रूप से स्वीकार करने का अधिकार सुरक्षित रखता है। बैंक बिना किसी कारण बताए सभी निविदाओं को अस्वीकार करने का अधिकार भी सुरक्षित रखता है।

कृते/-  
क्षेत्रीय निदेशक  
भारतीय रिज़र्व बैंक, चंडीगढ़



भारतीय रिज़र्व बैंक / Reserve Bank of India  
संपदा विभाग / Estate Department  
चंडीगढ़ / Chandigarh

### **E-Tender Notice**

#### **Renovation of Cash Area for Installation of New SBS Machines at Main Office Building of Reserve Bank of India, Sector-17A, Chandigarh**

Reserve Bank of India, Chandigarh invites E-Tender from eligible and willing firms for undertaking "*Renovation of Cash Area for Installation of New SBS Machines at Main Office Building of Reserve Bank of India, Sector- 17A, Chandigarh*". The estimated cost of work is ₹37.46 Lakh (including GST) only.

2. It is a limited e-tender. Only those firms which are empaneled with Estate Department, Reserve Bank of India, Chandigarh in Civil Repair Works (Trade No. 2) and Civil Interior and Renovation works (Trade No. 3) for undertaking the work costing more than ₹25 Lakh, under Category V are eligible to take part in the tender process. The tender document is available on the Bank's website [www.rbi.org.in](http://www.rbi.org.in) for download.

3. E-Tender shall be submitted online in two parts. Part-I of the e-tender will contain the Bank's standard technical and commercial conditions for the proposed work, which must be agreed to by the tenderers. Part-II of the e-tender will contain the Bank's schedule of quantities and tenderer's price bid to be submitted online.

4. The firms fulfilling the eligibility criteria should upload all the required documents at <https://www.mstcecommerce.com/eprocn> on or before September 06, 2024, 11:00 AM for consideration for the award of work.

5. Part-I of the e-tender will be opened on September 06, 2024 at 03:00 PM on MSTC website. The timeline of the e-tender is as follow:

A	E-Tender no	RBI/Chandigarh Regional Office/Estate/9/24-25/ET/281
B	Mode of Tender	e-Procurement System (Online Part I - Techno-Commercial Bid and Part II - Price Bid through MSTC portal ( <a href="https://www.mstcecommerce.com/eprocn">https://www.mstcecommerce.com/eprocn</a> ))
C	Estimated cost	₹37.46 Lakh (Rupees Thirty Seven Lakh Forty Six Thousand only) (Including GST)



D	Date of availability of E-Tender Document for download on RBI website	August 06, 2024 from 05:00 PM
E	Starting Date of E-Tender for submission of Part-I (Techno-Commercial Bid) and Part-II (Price Bid) at <a href="https://www.mstcecommerce.com/eproc">https://www.mstcecommerce.com/eproc</a>	August 06, 2024 from 05:00 PM
F	Date and time of pre-bid meeting	August 27, 2024 at 11:00 AM Venue: Estate Department, 3 <sup>rd</sup> Floor, Main Office Building, Reserve Bank of India, Central Vista, Sector-17, Chandigarh
G	Earnest Money Deposit (Only through NEFT)	<b>₹74,920/- (Rupees Seventy Four Thousand Nine Hundred Twenty Only)</b> <b>Beneficiary Name-</b> Reserve Bank of India <b>IFSC:</b> RBIS0CGPA01 (5th and 10th being zero) <b>Account No:</b> 186003001
H	Last date to deposit EMD	September 05, 2024
I	Closing Date of e-tender for submission of Techno-Commercial Bid & Price Bid	September 06, 2024 till 11:00 AM
J	Date & time of opening of Part I (Techno-Commercial Bid)	September 06, 2024 at 03:00 PM  Part II will be opened on same day if no deviation is submitted by bidders. Otherwise, the Part II will be opened on any other date which will be communicated to bidders through email.
K	Transaction Fee	Payment of transaction fee through MSTC payment gateway / NEFT in favour of MSTC Ltd

The Bank is not bound to accept the lowest tender and reserves the right to accept either in full or in part any tender. The Bank also reserves the right to reject all the tenders without assigning any reason thereof.

-SD-  
Regional Director  
Reserve Bank of India, Chandigarh

**Form of Tender**

Place \_\_\_\_\_

Date \_\_\_\_\_

The Regional Director,  
Reserve Bank of India,  
Estate Department  
Chandigarh

Dear Sir / Madam,

We have carefully examined the specifications and schedule of quantities relating to the works specified in the memorandum hereinafter set out and have visited and examined the installation site of the works specified in the said memorandum and having acquired the requisite information relating thereto as affecting the tender. I/We hereby offer to execute the works specified in the said memorandum within the time specified in the said memorandum at the rates mentioned in the attached Schedule of Quantities and in accordance in all respects with specifications and instructions in writing referred to in the conditions of tender, Articles of Agreement, General Instructions to the tenderers and special conditions, conditions hereinbefore referred to, specifications and schedule of quantities and with such materials as are provided for, by and in all other respects, in accordance with such conditions so far as they may be applicable.

**MEMORANDUM**

1	<b>Description of work</b>	Renovation of Cash Area for Installation of New SBS Machines at Main Office Building of Reserve Bank of India, Sector-17A, Chandigarh
2	<b>Estimated cost</b>	₹37.46 Lakh, inclusive of GST
3	<b>EMD</b>	₹74,920/- (Rupees Seventy Four Thousand Nine Hundred Twenty Only) NEFT to Beneficiary Name: RBI Chandigarh Beneficiary A/c No: 186003001 IFSC: RBIS0CGPA01 (5th and 10th being zero) Note: Kindly mention your name/ company name in the NEFT Transaction remarks.

2. We also agree that our tender will remain valid for acceptance by the Bank for 90 days from the date of opening of Part I of the tender and this period of validity can be extended for such period as may be mutually agreed between the Bank and us in

writing. We also agree to keep the earnest money valid during the entire period of validity of tender.

3. Should this Tender be accepted, I/we hereby agree to abide by and fulfil all the terms and Conditions of the Tender and in default thereof, to forfeit and pay to you or your successors, or assignees or nominees such sums of money as are stipulated in the conditions contained in the tender together with the written acceptance of the Contract.

4. I/We understand that you reserve the right to accept or reject any or all the tender either in full or in part without assigning any reason therefor. Should we fail to execute the Contract when called upon to do so, we do hereby agree that this sum shall be forfeited by us to the Reserve Bank of India.

5. The Tender is to be submitted in two parts. Part I contains all commercial terms conditions and technical particulars and Part II contains only the price bid.

Dated this \_\_\_\_ day of \_\_\_\_\_ 2024

For and on behalf of M/s

(Signature with seal)

Name \_\_\_\_\_

Designation: \_\_\_\_\_

Place \_\_\_\_\_

Date \_\_\_\_\_

Certified true copy of the Power of Attorney of the above signatory should be enclosed).

Witnesses

(1) Signature with name, address and date \_\_\_\_\_

(2) Signature with Name, address and date \_\_\_\_\_

<b>Reserve Bank of India (RBI)</b>	
<b>Estate Department</b>	
<b>Chandigarh</b>	
<b>E-Tender: Part I / Techno-commercial bid</b>	
<b><u>Section I: Commercial Conditions</u></b>	
1.1	<b><u>Name of work:</u></b> RBI CHANDIGARH invites tender of “ <b><i>Renovation of Cash Area for Installation of New SBS Machines at MOB of RBI at Sector-17A Chandigarh</i></b> ” in two Parts from eligible bidders. It is an E-Tender and the service provider is MSTC. Refer <a href="#">Annexure I</a> before proceeding further.
1.1.1	<b>Estimated cost of work: ₹37.46 Lakhs</b> (including GST)
1.1.2	<b>Earnest Money Deposit:</b> All the Bidders need to be submit EMD of ₹74,920/-. EMD amount must be reflected in our account on and before September 05, 2024.
1.1.3	<b>Time for completion of work: 120 days from the 14<sup>th</sup> day of date of work order.</b>
1.1.4	<b>Transaction fee of tender will be directly submitted at MSTC website</b>
1.1.5	Date of start of tender: <b>August 06, 2024</b>
1.1.6	Last date and time of submission of tender: <b>September 06, 2024 till 11:00 AM</b>
1.1.7	Date and time of opening of Part I of tender: <b>September 06, 2024 at 03:00 PM</b>
1.1.8	Date and time of opening of Part II of the tender: Part II will be opened on same day if there will be no deviation submitted by the bidder. Otherwise, the Part II will be opened on the other date which will be communicated to bidders through email.
1.1.9	<b>Contact Details:</b> 1) Sh. Nakul Nagde, Manager (Civil) Email: <a href="mailto:nakulnagde@rbi.org.in">nakulnagde@rbi.org.in</a> Mobile: 9829589139 2) Mohd. Arham, Junior Engineer (Civil) Email: <a href="mailto:mohammedarham@rbi.org.in">mohammedarham@rbi.org.in</a> Mobile: 8700569976 Estate Department, 3 <sup>rd</sup> Floor, RBI Chandigarh, PIN – 160017 Email: <a href="mailto:estatecharo@rbi.org.in">estatecharo@rbi.org.in</a> Phone Number: 0172-2722502  <b>Contact person (MSTC Ltd.)</b> 1) MSTC help desk: 07969066600

	<p>2) Mr Keshav Arora, Deputy Manager, <a href="mailto:cdgopn1@mstcindia.in">cdgopn1@mstcindia.in</a>; 9830430434,</p> <p>3) Mr Pankaj Kumar, Deputy Manager, <a href="mailto:cdgopn2@mstcindia.in">cdgopn2@mstcindia.in</a>, 7229068247</p> <p>Google hangout ID- (for text chat)- <a href="mailto:mstceproc@gmail.com">mstceproc@gmail.com</a></p>
1.1.10	<p><b>Eligibility Criteria:</b></p> <p>Only those bidders, who satisfy the following eligibility criteria shall be eligible to participate in the e-tender:</p> <p>I. Empaneled contractor of RBI (The Bank) CHANDIGARH office in Civil Repair Works (Trade No. 2) and Civil Interior and Renovation works (Trade No. 3) of more than Rs 25.00 Lakh.</p> <p>II. They should be in the valid empaneled Contractor list of RBI, Chandigarh under the appropriate category of works mentioned above.</p> <p>III. The Contractors should not have been banned for any reasons or any contract awarded to them should not have been terminated during the last 2 years on account of non-performance/ any other reasons decided by the Employer.</p>
1.2	<p><b><u>Tendering Process:</u></b> The tender documents can be downloaded from MSTC website. All corrigendum, addendum and further communication shall be forwarded through email and MSTC website only. The tenders for the above work in two parts i.e. Part I contains technical specifications &amp; terms and conditions. <u>Part II contains only rates of items which shall be inclusive of GST.</u> Tender shall be submitted on MSTC website (refer <a href="#">Annexure I</a>). Scan and Signed copy of Part I will be uploaded on MSTC website and rates of Part II will be directly submitted at MSTC website.</p>
1.3	<p><b><u>Part II (Financial bid):</u></b></p> <p>I. Part I will be opened on the date and time mention above.</p> <p>II. The Employer discourages stipulation of any additional conditions by the tenderers. However, in case the tenderers wish to include any condition, it shall be addressed as a special remark. The condition(s), if any, will be examined and after discussions with all the tenderers, the conditions that are acceptable to the Employer will be intimated to all the tenderers.</p> <p>III. Part II will be opened for those bidders who qualified in Part I of the tender.</p> <p>IV. If no special conditions are put forth by the bidders, Part II (Price Bid) of the tender shall also be opened thereafter on the same day or else Part II (Price Bid) shall be opened on a subsequent date which shall be intimated to the bidders.</p> <p>V. Tenders shall remain valid for acceptance by the Employer for a period of three months from the date of opening of the Part-1 of the tender which period may be extended by mutual agreement and the bidder shall not cancel or withdraw the tender during this period.</p> <p>VI. Bidder with lowest quoted amount in the Part II will be declared L1 bidder/successful bidder and if the rates are found workable/reasonable by the Bank, the tender will be awarded to lowest bidder/successful bidder.</p> <p>VII. In case two or more bidders being lowest bidder, all those bidders can quote a percentage above or below their tendered amount already submitted in part II. The quoting of such as a percentage above or below their tendered amount shall have a definite bearing on the condition/s the tenderers have to withdraw or additional benefit liable to be received as per the condition accepted by the Bank.</p>

	The letter containing the tenderer's quoting percentage above or below their quoted tendered amount should be submitted in sealed cover on or before date fixed to Estate Department, subsequently and advised to the tenderers. This letter together with already submitted tendered rate shall be called Part II, will be opened in presence of the representatives of firms on the due date advised.
1.4	The rates quoted in Part II of tender shall be firm and shall include charges of GST, levies, consumables, Material, labour, transport, insurance, sundries, removing of debris from the site, making good the damages etc. Bidders are advised to inspect the site before quoting. This is item rate tender and all items are to be executed as directed by Technical officer deputed in the Bank.
1.5	<p><b>Transaction fee is required to submit by all the intended bidders to MSTC website.</b> All bidder need to submit EMD through NEFT/ Net banking only (to A/c No. 186003001, IFSC- RBIS0CGPA01 of Reserve Bank of India, Chandigarh). Intimate/ forward the transaction details to <a href="mailto:estatecharo@rbi.org.in">estatecharo@rbi.org.in</a>. If bidder fails to submit the EMD, tender may be cancelled, and the firm may be delisted/blacklisted from further tendering process. EMD should be interest free and shall be returned to unsuccessful bidders after awarding the work and EMD of L1 bidder/ successful bidder will be returned submission of Performance Bank Guarantee in prescribed format</p> <p><b><u>EMD shall be forfeited if the Bidder:</u></b></p> <ul style="list-style-type: none"> <li>(i) makes misleading or false representations in the forms, statements and attachments submitted, has suppressed any material information, details of any legal proceedings pending in the court which might otherwise have created any impact on the eligibility criteria; or</li> <li>(ii) withdraws his Bid during the period of Bid validity; or does not sign the contract after award of Contract.</li> <li>(iii) has been blacklisted by any Government agency and the blacklisting is still in force</li> <li>(iv) If bidder fails to complete the work.</li> </ul>
1.6	<b><u>Validity of tender:</u></b> The tenders shall be valid for acceptance by the Bank for a period of 90 days from the date of opening of Part I of tender.
1.7	<p><b><u>Signing of Contract Agreement</u></b></p> <p>The successful bidder shall be bound to implement the Contract within 14 days from the date of work order. The cost of necessary stamp paper (₹100/-) for execution of the agreement shall be borne by the Bidder. The format of agreement is attached at <a href="#">annexure-II</a>.</p>
1.8	<b><u>Time Period:</u></b> Entire work shall be completed as indicated above, failing which liquidated damages at the rate of 0.25% of the contract value per week to a maximum of 10% of the contract value will be recovered for delay beyond the contractual period of completion. The work is allowed to be carried out during office hours (9:30 AM to 5:30 PM). The successful bidder is required to make entry passes before start of

	work for their workers. Special permission is required for working on weekends/holidays/late ours apart from regular entry pass.
1.9	<p><b><u>Extension of time: (before expiry of original date of completion)</u></b></p> <p>If the L1 bidder desires any extension of time for completion of work on grounds of there having been unavoidable hindrances in execution or any other ground, they shall apply in writing immediately weekend after the occurrence of the hindrance. Such application shall contain complete details of hindrances, which hindered the contractors in the execution of the work and reference to record of entry in the Hindrance Register. The Bank will grant the extension of time, without prejudice to the Bank's right to recover liquidated damages or compensation under relevant contract clause. The hindrance due to the Bank will not be the part of calculation of liquidated damages.</p>
1.10	<p><b><u>Safety and statutory measures:</u></b> The bidder shall take all safety measure during the execution of the work. The Bank will not accept any liability for any mishap / accident caused while working. The bidder shall indemnify and keep indemnified the Bank against all losses and claims, damages or compensation for breach of any provision of the Payment of Wages Act,1936 Minimum Wages Act 1948, Contract Labour (Regulation and Abolition) Act,1970, Payment of Bonus Act 1965 amended till date or any other labour law/statute in force in this regard.</p>
1.11	<p><b><u>Cleanliness:</u></b> All debris/packaging material etc shall be disposed of by the bidder as per the rules and regulation of local authorities concerned beyond the property limits and the site shall be kept free of safety/ fire hazards.</p>
1.12	<p><b><u>Security Deposit:</u></b></p> <p>(a) <b>Retention Money</b> of 5% of contract amount (including GST, interest free) will be deducted from all the bills including running and final bill i.e. 5% from each bill and same will be returned after completion of one year of defect liability period (DLP). All defect will be rectified free of cost during one year of DLP. All Penalties, if any mentioned in the tender, will be recovered from security deposit account.</p> <p>b) <b>Performance Bank Guarantee (PBG):</b> A Performance Bank Guarantee in prescribed Format as per <a href="#">Annexure–III</a>, for an amount equal to 5% of the contract value, valid for the <u>entire period of currency of contract (or minimum 06 months)</u> shall be submitted by the successful tenderer(s) for due fulfilment of the contractual obligations which will be released after virtual completion of the work. EMD of successful bidder will be refunded only after submission the Performance Bank Guarantee.</p> <p><b>The vendor(s) has to extend the period of validity of PBG up to extended time in case any extension of time for completion of work is granted by the Bank. Bank will not pay any charges for extending the validity of PBG for such extended period</b></p>

1.13	<p><b><u>Non-Disclosure clause:</u></b> The Bidder shall not disclose directly or indirectly any information, materials and details of the Bank's infrastructure/systems/equipment etc., which may come to the possession or knowledge of the Bidder during the course of discharging its contractual obligations in connection with this agreement, to any third party and shall at all times hold the same in strictest confidence. The Bidder shall treat the details of the contract as private and confidential, except to the extent necessary to carry out the obligations under it or to comply with applicable laws. The Bidder shall not publish, permit to be published, or disclose any particulars of the works in any trade or technical paper or elsewhere without the previous written consent of the Employer. The Bidder shall indemnify the Employer for any loss suffered by the Employer as a result of disclosure of any confidential information. Failure to observe the above shall be treated as breach of contract on the part of the Bidder and the Employer shall be entitled to claim damages and pursue legal remedies. The Bidder shall take all appropriate actions with respect to its employees to ensure that the obligations of non-disclosure of confidential information under this agreement are fully satisfied. The Bidder's obligations with respect to non-disclosure and confidentiality will survive the expiry or termination of this agreement for whatever reason.</p>
1.14	<p>The Bidder / Agency shall comply with the provisions of “the Sexual Harassment of women at work place (Prevention, Prohibition and Redressal) Act, 2013”. In case of any complaint of sexual harassment against its employee within the premises of the bank, the complaint will be filed before the Internal Complaints Committee constituted by the Bidder / Agency and the Bidder/Agency shall ensure appropriate action under the said Act in respect to the complaint. The bidder shall be responsible for educating its employees about prevention of sexual Harassment at work place and related issues.</p> <p>Any complaint of sexual harassment from any aggrieved employee of the bidder against any employee of the Bank shall be taken cognizance of by the Regional Complaints Committee constituted by the Bank.</p>
1.15	<p><b>Termination of Contract by the Employer:</b> If the Contractor being an individual or a firm commits any “act of insolvency”, or shall be adjudged an insolvent or being an Incorporated Company shall have an order for compulsory winding up made against it or pass an effective resolution for winding up voluntarily or subject to the supervision of the Court and the Official Assignee of the Liquidator, in such acts of insolvency or winding up, as the case may be, shall be unable, within seven days after notice to him requiring him to do so, to show the reasonable satisfaction of the Employer that he is able to carry out and fulfil the Contract and to give security therefor, if so required by the Employer.</p> <p>Or if the Contractor (whether an individual, firm or Incorporated Company) shall suffer execution or other process of Court attaching property to be issued against the Contractor,</p>



Or shall suffer any payment under this Contract to be attached by or on behalf of any of the creditors of the Contractor,

Or shall assign or sublet this Contract without the consent in writing of the Employer first had obtained,

Or shall charge or encumber this Contract or any payments due or which may become due to the Contractor hereunder,

Or if the Employer determine that the Contractor

- (i) has abandoned the Contract, or
- (ii) has failed to commence the works, or has without any lawful excuse under those Conditions suspended the progress of the works for 14 days after receiving from the Employer notice to proceed, or
- (iii) has failed to proceed with the works with such due diligence and failed to make such due progress as would enable the works to be completed within the time agreed upon, or
- (iv) has failed to remove materials from the site or to pull down, and replace work for seven days after receiving written notice that the said materials or work were condemned and rejected by the Employer under these Conditions or
- (v) has neglected or failed persistently to observe and perform all or any of the acts, matters or things by this Contract to be observed and performed by the Contractor for seven days after written notice shall have been given to the Contractor requiring the Contractor to observe or perform the same.

Then and in any of the said cases, the Employer may notwithstanding any previous waiver, after giving seven days' notice in writing to the Contractor, determine the Contract and liabilities of the Contractor, the whole of which shall continue in force fully as if the Contract had not been so determined, and as if the works subsequently executed had been executed by or on behalf of the Contractor and further, the Employer by his agents or servants may enter upon and take possession of the works and all plant, tools, scaffoldings, machinery and materials lying upon the premises or the adjoining lands or roads, and use the same as his own property or may employ the same by means of his servants and workmen in carrying on and completing the works or by employing any other Contractor or other person or persons to complete the works, and the Contractor or other person or persons employed for completing and finishing or using the materials and plant for the works. when the works shall be completed or as soon thereafter as convenient, the Employer shall give a notice in writing to the Contractor to remove his surplus materials and plant, and should the Contractor fail to do so within a period of twenty days after receipt thereof by him, the Employer may sell the same by public auction, and give credit to the Contractor for the net amount realized. The Employer shall thereafter ascertain in writing under his hand what (if anything) shall be due or payable to, or by the Employer, for the value of the said plant and materials so taken possession of by the Employer and the expense or loss which the Employer shall have been put to in procuring the works to be completed, and the amount, if any, owing to the Contractor and the amount which shall thereupon be paid by the Employer to the Contractor or by the Contractor

	to the Employer, as the case may be, and the decision of the Employer shall be final and conclusive between the parties.
1.16	<p><b><u>Termination of Contract by Contractor</u></b></p> <p>If payment of the amount payable by the Employer shall be in arrears and unpaid for thirty days after notice in writing requiring payment of the amount as aforesaid shall have been given by the Contractor to the Employer or if the Employer shall repudiate the Contract, or if the works be stopped for three months under the order of the Employer or by any injunction or other order of any Court of Law, then and in any of the said cases, the Contractor shall be at liberty to determine the Contract by notice in writing to the Employer and he shall be entitled to recover from the Employer, payment for all works executed and for any loss he may sustain upon any plant or materials supplied or purchased or prepared for the purpose of the Contract. In arriving at the amount of such payment, the net rates contained in the Contractor's original Tender shall be followed, or where the same may not apply, valuation shall be made in accordance with Clause</p>
1.17	<p><b><u>Insurance:</u></b> The contractor shall take all insurances at his cost to cover all kinds of risks from the time the equipment /materials leave the manufacturer's works till handing over work to the Bank, in the joint names of the Bank and the contractor and it shall cover the following risks.</p> <p>I) Work man compensation for working men  II) Third party liability (@10% of contract cost of work per accident maximum for 3 period)  III) Contractor's all risk policies for contract value</p> <p><b>Note:</b></p> <p>1. These policies shall be valid till the completion of the work and shall be submitted prior to obtaining any permission to work at site. If the contractor does not provide these policies, the Bank reserves the right to take the above insurance policies themselves and/or recover the cost thereof from the bill of the contractor.</p> <p>2. The vendor(s) need to extend the period of validity of all type of insurance up to extended time in case any extension of time for completion of work is granted by the Bank. Bank will not pay any charges for extending the validity of all type of insurance for such extended period.</p>
1.18	<p><b><u>Payment Condition:</u></b></p> <p>(a) Minimum value of interim bill shall be 15.00 lakh and will be paid within 30 days from the date of submission of all the required documents (2 Nos Computerised spiral bind measurement book, tax invoice, guarantee/warranty of item of work, supplier's bill (if required) etc.</p> <p>(b) Final Bill will be paid after satisfactory completion of work and within 45 days from the date of submission of all the required documents (2 nos. Computerised spiral bind measurement book, tax invoice, guarantee/warranty of item of work, supplier's bill (if required) etc.</p> <p>(c) <b>Security deposit</b> of 5% of total value of work (including GST, interest free) will be deducted from the bill and same will be returned after completion of one year of defect liability period (DLP). All defects will be rectified free of cost during one</p>

	<p>year of DLP. All Penalties, if any mentioned in the tender, will be recovered from security deposit.</p> <p>(d) The Employer shall have power to withhold any payment if the works or any parts thereof are not being carried out to his satisfaction.</p>
1.19	<p>At any time after acceptance of the tender, the Employer shall, for any reasons whatsoever, not require the whole or any part of the works to be carried out, the Employer shall give notice in writing to the Contractor who shall have no claim to any payment of compensation or otherwise whatsoever on account of any profit or advantage which he might have derived from the execution of the whole works.</p>
1.20	<p><b><u>Extra Item:</u></b> If the quantity of any of the tender items increases 25% beyond the tender item quantity, such items shall be treated as Extra items and the rates of these shall be prepared based on market rate analysis.</p>
1.21	<p><b><u>Prices for extra etc. ascertainment of</u></b></p> <p>The Contractor may, when authorised by Employer, add to, omit from, or vary the works shown upon the drawings, or described in the Specification, or included in the Schedule of Quantities, but the Contractor shall make no addition, omission or variation without such authorization or direction. A verbal authority or direction by the Employer shall, if confirmed by him in writing within seven days, be deemed to have been given in writing</p> <p>No claim for any extra shall be allowed unless it shall have been executed with the concurrence of the Employer as herein mentioned. Any such extra is herein referred to as authorised extra and shall be made in accordance with the following provisions.</p> <p>(a) (i) The net rates or prices in the original tender shall determine the valuation of the extra work where such extra work is of similar character and executed under similar conditions as the work priced therein.</p> <p>(ii) Rates for all items, wherever possible, should be derived out of the rates given in the Priced Schedule of Quantities.</p> <p>(b) The net prices of the original tender shall determine the value of the items omitted, provided if omissions vary the conditions under which any remaining items of works are carried out, the prices for the same shall be valued under sub-clause (c) hereof.</p> <p>(c) Where the extra works are not of similar character and/or executed under similar conditions as aforesaid or where the omissions vary the conditions under which any remaining items of works are carried out or if the amount of any omission or additions relative to the amount of the whole of the Contract works or to any part thereof shall be such that in the opinion of the Employer the net rate or price contained in the Priced Schedule of Quantities or tender or for any item of the works involves loss or expense beyond that reasonably contemplated by the Contractor or is by reason of such omission or addition rendered unreasonable or</p>

	<p>inapplicable, the Employer shall fix such other rate or price as in the circumstances he shall think reasonable and proper based on the rate analysis (with supporting documents) submitted by the contractor taking establishment costs, overheads and profit @ 15%.</p> <p>(d) Where extra work cannot be properly measured or valued, the Contractor shall be allowed day work that in which the work has been executed. prices at the net rates in accordance with the local day work rates and wages for the district, provided that in either case vouchers specifying the daily time and materials employed, be delivered for verification to the Employer at or before the end of the week following.</p>
1.22	<p><b><u>Removal of improper works:</u></b></p> <p>The Employer shall, during the progress of the works, have power to order in writing from time to time the removal from the works within such reasonable time or times, as may be specified in the order, of any materials which in the opinion of the Employer are not in accordance with the Specifications or the instructions of the Employer, the substitution of proper materials, and the removal and proper re-execution of any work executed with materials or workmanship not in accordance with the Drawings and Specifications or instruction, and the Contractor shall forthwith carry out such order at his own cost. In case of default on the part of the Contractor to carry out such order, the Employer shall have the power to employ and pay the other persons to carry out the same, and all expenses consequent thereon, or incidental thereto shall be borne by the Contractor, or may be deducted by the Employer from any moneys due, or that may become due, to the Contractor.</p>
1.23	<p><b><u>Special Conditions of contract:</u></b></p> <ol style="list-style-type: none"> <li>1. Quantity of the material to be procured is responsibility of the vendor. Bank is not responsible for excess/shortage for quantity of material procured and same will not be considered for the cause of delay.</li> <li>2. Granite flooring may be laid in Combination of two or more shades and/or texture of Granite Stone. Necessary labor factor shall be considered for laying the granite in combinations.</li> <li>3. Vendor need to submit/execute sample of work for each item of work for approval regarding the basic price, specifications, shade/color/pattern of each of the item before procurement and execution of work.</li> <li>4. All the material should be of approved make and specifications.</li> <li>5. Dismantling work should be planned in consultation with the Bank's engineer</li> <li>6. Removal of debris/cleaning of the work area and its adjacent area should be done on daily basis. On intimation (verbal or written) by the Bank to remove the debris, it should be get removed immediately and in case of failure, penalty of ₹500/- (including GST) per instance will be levied on.</li> <li>7. Vendor(s) need to get their work checked by the Bank's designated official at each stage of work.</li> </ol>

8. **Quality of work should be best in class. In case of improper work, contractor need to get it rectified at their risk and cost.** Materials shall be of the best-approved quality obtainable and they shall comply with the respective IS specifications (for those materials covered by BIS), wherever applicable.
9. Safety of workmen should be insured by providing proper and required PPE's to them.
10. Vendor(s) need to ensure the implementation of Covid-19 guidelines issued by Government time to time.
11. The tenderer is advised to inspect the proposed site of work to understand the scope of work. The rates shall be quoted considering the site conditions/Undulations of the work area, distance between designated storage area and working site, condition of existing surface/substrate and other factors. Any claim regarding the variation of the quantity of item / sub item of the work due to non-consideration of the above factors will not be entertained and will be rejected.
12. Proper care should be taken during the demolition and disposal of debris.
13. Area under consideration for work will be handed over to the successful bidder only for said work. Contractor should get the approval of the brand/ specification/color and shade of material before start of work. Contractor is advised to isolate the area of work from the remaining area by suitable barricading and partitioning before start of work. Extreme care should be taken to see that the existing structures/fittings/finishes/plants/trees in nearby area or within the Bank premises are not damaged/ defaced due to the work. Any damages caused during the execution of the work shall be made good at the cost and responsibility of the contractor.
14. The work should be carried out with the co-ordination with Bank's Engineer/care taker before start of work. Vendor need to inform the care taker to ensure that all the goods kept in the nearby area have been removed.
15. All the electrical fittings and fixtures are to be covered. Any damages to the fixtures and fittings will be recovered from the bill of the contractor.
16. The successful tenderer must co-operate with the other Contractors appointed by the Employer so that the work shall proceed smoothly with the least possible disturbance / delay
17. Contractors shall acquaint themselves of the security procedures of Reserve Bank of India, Chandigarh. They shall make necessary arrangements to obtain prior permissions and passes. Any delays in work on account of delay in obtaining such passes/permissions; required for working shall be accounted as delay on Contractor's part.
18. Work shall be executed using makes/brands of materials/chemicals stipulated in the tender. Wherever contractors propose to use equivalent make, the same shall be done with prior approval of Banks Engineer in writing. In such cases the contractor shall submit necessary documents / test reports and carry out necessary tests as required by the Bank's Engineer to prove that the proposed

	<p>materials conform to the technical parameters stipulated in the tender. Any additional expenditure and time due to this shall be solely on contractor's account and no claims whatsoever shall be entertained in this regard</p> <p>19. The contractor shall submit a properly planned &amp; prepared work program to the Employer before commencement of the work so as to enable the Employer to intimate other agencies in advance for smooth working, progress and coordination and the time schedule in the work program should be strictly adhered to,</p> <p>20. It is the Contractor's responsibility to ensure that the materials delivered on site within the specified timelines and the delivered material is safeguarded from the time of its purchase until work is handed over in a finished form. It is recommended to store the materials in a pre-decided, location on clean and dry surface.</p> <p>21. Price adjustment will be made only on the actual quantity measured. The price adjustment will be made for the difference between the basic rate and the actual market / material purchase rate and 15% profit thereon in the rate quoted for respective item in the tender.</p> <p>22. Basic rate indicates cost of material at site excluding GST, transportation charges, sales tax, excise/custom duty, VAT, SAT, Octroi or any other tax and duty or other levy charged by the Central Government or State Government or local authority as applicable.</p> <p><b><u>Adjustment in rates In Case of difference in Basic price of material</u></b></p> <p>If there is difference in Basic price of material, the quoted rates for item including fixing / installation / laying etc of that items, will be adjusted as below- For each Rs. 1.00 (One rupee) variation in basic rates of per unit of that material, there will be Rs. 1.357 (Multiplying factor) for adjustment in the rates.</p> <p><b><u>Revised rates =</u></b>  <b><u>Rates quoted in the tender + (Actual basic rate of approved material – basic rates mentioned in the tender) X CPOH @ 15% X GST @ 18%</u></b></p> <ul style="list-style-type: none"> <li>➤ <u>CPOH @ 15% is the 15% of the difference in basic prices of material</u></li> <li>➤ <u>GST @ 18% is the 18% of the the difference in basic prices of material</u></li> <li>➤ <u>Necessary documents for verification of the rates need to be supplied before commencement of work at site.</u></li> </ul>
Date	Signature of the firm
Place	(By a person holding the Authority/Power of Attorney)

### **Section-II (Scope of the work)**

**Name of work: Renovation of Cash Area for Installation of New SBS Machines at MOB of RBI at Sector-17A Chandigarh**

**Scope of Work:**

- 1) Submission and Approval of samples of Kota Stone/Tiles, ACP sheets, uPVC profiles and fittings, paints and polycarbonate multiple wall sheet etc. in accordance with the basic rates/ technical specifications as mentioned in the tender.
- 2) Executing the samples of each item of work at site for approval by the Bank. In case of modification/alteration in the work, carry out the same for approval.
- 3) Supply the materials as per the approvals and specifications mentioned in the tender.
- 4) Erection of Double steel scaffolding in interior portion of the Building.
- 5) Dismantling/demolition as per tender items.
- 6) Disposal of debris dismantled and unserviceable items.
- 7) Assessment of the surface condition of the dismantled surface for unevenness/depression etc. and carry out the repair/correction and PCC work
- 8) Taking exact measurement of the work to be carried out.
- 9) Repairs, Plaster work, scaffolding etc
- 10) Flooring work in flooring as per the design and approved shades
- 11) MS structural Steel Work, ACP wall cladding works etc. as per the approved design and shades
- 12) Application of Putty on Walls as well as ceiling surfaces.
- 13) Re-painting/Re-polishing works.

Date

Signature of the Firm

**List of approved makes / manufacturers of materials:**

1. All materials to be used in the work shall strictly conform to the detailed technical specifications under each item.
2. If the approved brands mentioned are not available in the market, equivalent material with written approval of the Bank's Engineer only shall be used in the work. Wherever the contractor proposes to use equivalent makes (i.e. other than those specified), the same shall be done with prior approval of the Bank's Engineer. In such cases, it is the responsibility of the contractor to prove, to the satisfaction of the Bank's Engineer, with necessary technical data / documents / tests reports that the equivalent materials proposed to be used in the work conform to all the technical specifications / parameters stipulated in the specifications. Any additional expenditure and time on account of this shall be solely on contractor's account and no claims whatsoever shall be entertained by the Employer in this regard.

Sr. No.	Description of Material	Approved Makes
1.	Polymer modified cementitious mortar, repair chemicals, sealants, tile adhesives, grouts etc.	M/s. Fosroc India Limited, M/s. Pidilite, M/s. BASF, M/s. SIKA M/s. MC Baushumie, M/s. STP, M/s. Bal Endura or approved equivalent make.
2.	Cement	A.C.C, Ultra Tech, Ambuja, Birla, or approved equivalent make.
3.	White Cement / White Cement based Putty	Birla White, JK white or approved equivalent make
4.	Ready-mix Plaster, cement mortar polymer modified mortar etc.	Ultra-Tech (Readyplast), ACC, Wallplast (Easy Plast), Laticrete (Powerplast) or approved equivalent make.
5.	Adhesives	Fevicol SH, Araldite, Vamicol, or approved equivalent make
6.	Tiles	H R Johnson, Kajariya, somany, RAK, Nitco or approved equivalent make
7.	Paint	Asian, Nerolac, Dulux, Berger or approved equivalent make.
8.	Laminate	Decolam, Formica, Kitlam, Kitmica, sunmica, Sundek or any other approved equivalent make



	9.	MDF Board	Newud or any other approved equivalent make
	10.	Aluminium extruded section	Jindal or any other approved equivalent make
	11.	Aluminium Composite panel	Alstone/Euro Bond / Alto Bond/ Alu Decor/ Alutech/ Evabond/ Alucobond/ Alpolic or approved equivalent
	12.	Stainless Steel (304 Grade)	Jindal, Hindalco, SAIL, Viega or approved equivalent
	13.	Structural Steel	Tata Steel, SAIL, Jindal or approved equivalent
	14.	uPVC profile	Finesta, Aluplast, Prominence, Kommerlinge or approved equivalent
	15.	Glass	Modi guard, Saint gobain or approved equivalent
Date			Signature of the firm

### **Section-III**

#### **Technical Specification of the work**

##### **GENERAL**

The carriage and stacking of materials shall be done as directed by the Bank's Engineer. Any tools and plants, required for the work shall be arranged by the Contractor..

##### **RESPONSIBILITY FOR LOSS OR DAMAGE**

Loading, carriage, unloading and stacking shall be done carefully to avoid loss or damage to the materials. In case of any loss or damage, recovery shall be effected from the Contractor at twice the Departmental issue rates of the materials. If the departmental issue rates of the materials are not available then the recovery shall be effected at twice the prevailing market rates as determined by the Bank's Engineer.

##### **MODE OF CARRIAGE**

Depending upon the feasibility and economy, the Bank's Engineer shall determine the mode of carriage viz. whether by mechanical transport or manual labour.

##### **GENERAL CONSIDERATION FOR STACKING AND STORAGE**

###### **Planning of Storage Layout**

For any site, there should be proper planning of the layout for stacking and storage of different materials, components and equipment's with proper access and proper maneuverability of the vehicles carrying the material. While planning the layout, the requirements of various materials, components and equipments at different stages of construction shall be considered. For further details, refer IS- 4082.

Material shall be stored in such a manner as to prevent deterioration or intrusion of foreign matter and to ensure the preservation of their quality and fitness for the work.

##### **PROTECTION AGAINST ATMOSPHERIC AGENCIES**

Materials stored at site, depending upon the individual characteristics, shall be protected from atmospheric actions, such as rain, sun, winds and moisture to avoid deterioration.

## **PROTECTION AGAINST FIRE AND OTHER HAZARDS**

Materials like timber, coal, paints, etc. shall be stored in such a way that there may not be any possibility of fire hazards. Inflammable materials like kerosene and petrol, shall be stored in accordance with the relevant rules and regulations so as to ensure the desired safety during storage. Stacks shall not be piled so high as to make them unstable under fire fighting conditions and in general they shall not be more than 4.5 m in height. The provisions given in IS 13416 (part 5) shall be followed.

## **QUALITY**

All materials for incorporation into the works shall be of the best quality of their respective kinds as specified herein and shall comply strictly with the tests prescribed hereinafter or, where tests are not laid down in list Specification, with the requirements of the latest edition of the relevant Indian Standards approved by the Engineer.

## **SAMPLES**

Samples of all materials proposed to be used or incorporated in the works and to be supplied by the Contractor may be called for at any time by the Engineer or his Representative.

### **Approval of Samples, Handling of material:**

1. Submit manufacturer's standard size sample of sections of all size that are to be used to the work.
2. Submit samples that are large enough to exhibit the technical specifications color and other properties.
3. Deliver materials to site in original factory wrappings and containers, clearly labeled with identification of manufacturer, brand name,
4. Store materials in original undamaged packages and containers, inside well-ventilated area protected from weather, moisture, soiling, extreme temperatures, humidity; laid flat, blocked off ground to prevent sagging and warping.
5. Do not stack packages higher than recommended by manufacturer.

## **MODE OF MEASUREMENT**

The method of measurement for various items in the tender shall be generally in accordance with the IS: 1200 unless otherwise specifically stipulated in this tender document.

## **MATERIALS**

Materials shall be of the best-approved quality obtainable and they shall comply with the respective IS specifications (for those materials covered by BIS). Samples of all materials shall be got approved before placing an order and the approved sample shall be deposited in the Bank.

1. Materials shall be of the best approved quality obtainable and they shall comply with the respective latest IS specification.
2. Samples of all materials shall be got approved before placing an order and the approved sample shall be deposited with the Bank.
3. In case of non-availability of materials in metric sizes, the nearest size in FPS units shall be provided with the prior approval of the Engineer for which neither extra will be paid nor any rebate shall be recovered.
4. Under Exceptional circumstances, when bank may in the opinion to test any of the material from third party, below mentioned for the independent test shall be followed:

Any of the material may be tested in any government/ NABL certified testing laboratory approved by the Assistant Manager/ Manager (Tech), as per the testing guidelines issued by the Employer, which can be perused by the Contractor from the Bank. Results of such tests in original issued by the laboratory shall be submitted to the Bank with Assistant Manager/ Manager (Tech). The entire charges connected with such testing including for repeated tests if ordered by the Engineer shall be borne by the Contractor.

The frequency, the procedure for the testing and acceptance criteria will be as stated in the respective I.S codes. The Contractor shall at his own expenses supply and deliver to a Testing House or Analyst such materials as may be directed by the Engineer. Should the result of any test be unsatisfactory to the Engineer or his Representative, the materials represented will be rejected. The costs of all the tests shall be borne by the contractor.

## **Dismantling and Demolition**

**(i) Deconstruction/Dismantling** – Means a selective demolition in which salvage, reuse and recycling of demolished structure is maximized. The term ‘Dismantling’ implies carefully separating the parts without damage and removing. This may consist of dismantling one or more parts of the building as specified or shown on the drawings.

Applicable to doors, windows, aluminum partition, material with salvage value.

**(ii) Demolition:** The term ‘Demolition’ implies breaking up. This shall consist of demolishing whole or part of work either manually or using mechanical force (various equipment) or by implosion using explosion, including all relevant items as specified or shown on the drawings.

Applicable to Brickwork, flooring and other masonry structure. Generates Debris with no or little value from economical point of view.

### **Precautions**

1. All materials obtained from dismantling or demolition shall be the property of the Government unless otherwise specified and shall be kept in safe custody until they are handed over to the Engineer-in- Charge/ authorized representative.
2. The demolition shall always be well planned before hand and shall generally be done in reverse order of the one in which the structure was constructed. The operations shall be got approved from the Engineer-in-Charge before starting the work.
3. Due care shall be taken to maintain the safety measures prescribed in IS 4130 and construction and demolition waste management rules 2016 shall be followed.
4. Necessary propping, shoring and or under pinning shall be provided to ensure the safety of the adjoining work or property before dismantling and demolishing is taken up and the work shall be carried out in such a way that no damage is caused to the adjoining work or property. Wherever specified, temporary enclosures or partitions and necessary scaffolding with suitable double scaffolding and proper cloth covering shall also be provided, as directed by the Engineer-in-Charge. It shall be ensured that no dust is generated while demolishing. Demolition Rules – 2016 shall be followed.
5. Necessary steps shall be taken to keep noise and dust nuisance to the minimum. All work needs to be done under the direction of Engineer-in-Charge. Helmets, goggle, safety belts etc., should be used whenever required and as directed by the Engineer-in-Charge. The demolition work shall be proceeded with in such a way that it causes the least damage and nuisance to the adjoining building and the public. Barricading

shall be provided as per NGT guidelines.

6. Dismantling shall be done in a systematic manner. All materials which are likely to be damaged by dropping from a height or by demolishing roofs, masonry etc. shall be carefully removed first. Chisels and cutters may be used carefully as directed. The dismantled articles shall be removed manually or otherwise, lowered to the ground (and not thrown) and then properly stacked as directed by the Engineer-in-Charge.
7. Where existing fixing is done by nails, screws, bolts, rivets, etc., dismantling shall be done by taking out the fixing with proper tools and not by tearing or ripping off.
8. Any serviceable material, obtained during dismantling or demolition, shall be separated out and stacked properly as directed by the Engineer-in-Charge within a lead of 50 meters. All unserviceable materials, rubbish etc. shall be disposed off at authorized locations by urban local bodies as directed by the Engineer-in-Charge.
9. The contractor shall maintain/disconnect existing services, whether temporary or permanent, wherever required by the Engineer-in-Charge.

## **Brick Work**

**Bricks used in the masonry may be of the following type.**

### **Classification**

Bricks/Brick tiles shall be classified based on their minimum compressive strength as given below

**Table**

<i>Class Designation</i>	<i>Average compressive strength</i>			
	<i>Not less than</i>		<i>Less than</i>	
	<i>N/mm<sup>2</sup></i>	<i>(kgf/cm<sup>2</sup>)</i>	<i>N/mm<sup>2</sup></i>	<i>(kgf/cm<sup>2</sup>)</i>
12.5 (125)	12.5	125	15.0	150
10 (100)	10	100	12.5	125
7.5 (75)	7.5	75	10	100
5 (50)	5	50	7.5	75
3.5 (35)	3.5	35	5.0	50

The Common Burnt Clay Bricks shall conform to IS:1077 and shall be hand moulded or machine moulded. They shall be free from nodules of free lime, visible cracks, flaws warpage and organic matter, have a frog 100 mm in length 40 mm in width and 10 mm to 20 mm deep on one of its flat sides. Bricks made by extrusion process and brick tiles may not be provided with frogs. Each brick shall be marked (in the frog where provided) with the manufacturer's identification mark or initials.

### **Soaking of Bricks**

Bricks shall be soaked in water before use for a period for the water to just penetrate the whole depth of the bricks. Alternatively bricks may be adequately soaked in stacks by profusely spraying with clean water at regular intervals for a period not less than six hours. The bricks required for masonry work using mud mortar shall not be soaked. When the bricks are soaked they shall be removed from the tank sufficiently early so that at the time of laying they are skin -dry. Such soaked bricks shall be stacked on a clean place where they are not again spoiled by dirt earth etc.

### **Laying**

Bricks shall be laid in English Bond (Fig. given below) unless otherwise specified. For brick work in half brick wall, bricks shall be laid in stretcher bond. Half or cut bricks shall not be used except as closer where necessary to complete the bond. Closers in such

cases, shall be cut to the required size and used near the ends of the wall. Header bond shall be used preferably in all courses in curved plan for ensuring better alignment.

Note: Header bond shall also be used in foundation footings unless thickness of walls (width of footing) makes the use of headers impracticable. Where thickness of footing is uniform for a number of courses, the top course of footing shall be headers.

All loose materials, dirt and set lumps of mortar which may be lying over the surface on which brick work is to be freshly started, shall be removed with a wire brush and surface wetted. Bricks shall be laid on a full bed of mortar, when laying, each brick shall, be properly bedded and set in position by gently pressing with the handle of a trowel. Its inside face shall be buttered with mortar before the next brick is laid and pressed against it. Joints shall be fully filled and packed with mortar such that no hollow space are left inside the joints.

The walls shall be taken up truly in plumb or true to the required batter where specified. All courses shall be laid truly horizontal and all vertical joints shall be truly vertical. Vertical joints in the alternate course shall come directly one over the other. Quoin, Jambs and other angles shall be pro-perly plumbed as the work proceeds. Care shall be taken to keep the perpend properly aligned within following maximum permissible tolerances :

- (a) Deviation from vertical within a storey shall not exceed 6 mm per 3 m height.
- (b) Deviation in verticality in total height of any wall of building more than one storey in height shall not exceed 12.5 mm.
- (c) Deviation from position shown on plan of any brick work shall not exceed 12.5 mm.
- (d) Relative displacement between load bearing wall in adjacent storeys intended to be vertical alignments shall not exceed 6 mm.
- (e) A set of tools comprising of wooden straight edge, masonic spirit levels, square, 1 metre rule line and plumb shall be kept on the site of work for every 3 masons for proper check during the progress of work.

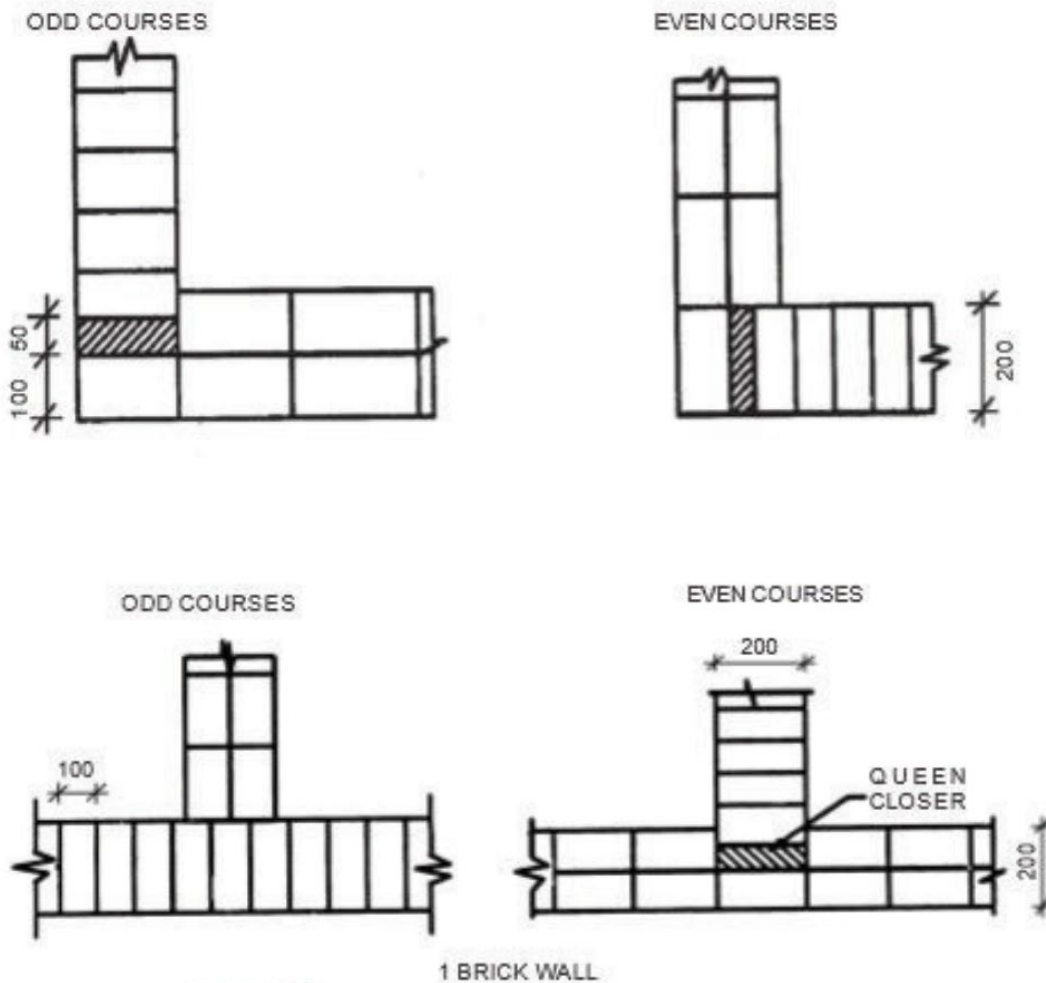

**Brick Bond:**

(Fig only for illustration purpose)

**The brick work shall be built in uniform layers.**

1. No part of the wall during its construction shall rise more than one metre above the general construction level. Parts of wall left at different levels shall be raked back at an angle of 45 degrees or less with the horizontal. Tooothing shall not be permitted as an alternative to raking back. For half brick partition to be keyed into main walls, indents shall be left in the main walls.
2. All pipe fittings and specials, spouts, hold fasts and other fixtures which are required to be built into the walls shall be embedded, as specified, in their correct position as the work proceeds unless otherwise directed by the Engineer-in-Charge.
3. Top courses of all plinths, parapets, steps and top of walls below floor and roof slabs shall be laid with brick on edge, unless specified otherwise. Brick on edge laid in the top courses at corner of walls shall be properly radiated and keyed into position to form cut (maru) corners. Where bricks cannot be cut to the required shape to form

cut (maru) corners, cement concrete 1:2:4 (1 cement : 2 coarse sand : 4 graded stone aggregate 20 mm nominal size) equal to thickness of course shall be provided in lieu of cut bricks.

4. Bricks shall be laid with frog (where provided) up. However, when top course is exposed, bricks shall be laid with frog down. For the bricks to be laid with frog down, the frog shall be filled with mortar before placing the brick in position.
5. In case of walls one brick thick and under, one face shall be kept even and in proper plane, while the other face may be slightly rough. In case of walls more than one brick thick, both the faces shall be kept even and in proper plane.
6. To facilitate taking service lines later without excessive cutting of completed work, sleeves (to be paid separately) shall be provided, where specified, while raising the brick work. Such sleeves in external walls shall be sloped down outward so as to avoid passage of water inside.
7. Top of the brickwork in coping and sills in external walls shall be slightly tilted. Where brick coping and sills are projecting beyond the face of the wall, drip course/throating (to be paid separately) shall be provided where indicated.
8. Care shall be taken during construction that edges of jambs, sills and projections are not damaged in case of rain. New built work shall be covered with gunny bags or tarpoulin so as to prevent the mortar from being washed away. Damage, if any, shall be made good to the satisfaction of the Engineer-in-Charge.

### **Rate**

The rate shall include the cost of materials and labour required for all the operations described above except the vertical reinforcement and its encasement in cement mortar or cement concrete. The rate shall also include the following :

- (a) Raking out joints or finishing joints flush as the work proceeds;
- (b) Preparing tops of existing walls and the like for raising further new brick work.
- (c) Rough cutting and waste for forming gables, splays at eaves and the like.
- (d) Leaving holes for pipes upto 150 mm dia. and encasing hold fasts etc.
- (e) Rough cutting and waste for brick work curved in plan and for backing to stone or other types of facing.
- (f) Embedding in ends of beams, joists, slabs, lintels, sills, trusses etc.
- (g) Bedding wall plates, lintels, sills, roof tiles, corrugated sheets, etc. in or on walls if not covered in respective items and

- (h) Leaving chases of section not exceeding 50 cm in girth or 350 sq cm in cross-section.
- (i) Brick on edge courses, cut brick corners, splays reveals, cavity walls, brick works curved on plan to a mean radius exceeding six metres.

## **Kota Stone Flooring**

**1.1 Stone Slabs** The slab shall be of selected quality, hard, sound, dense and homogeneous in texture, free from cracks, decay, weathering, and flaws. They shall be hand or machine cut to the requisite thickness as indicated and they shall be of uniform color. (in case of non-uniformity in the lot of Kota stone, whole lot will be get rejected) The slabs shall have the top (exposed) face polished before being brought to site. Before starting the work, Contractor shall get the sample of slabs approved by the Engineer-in-Charge.

**1.2 Dressing of Slabs** Every slab shall be cut to the required size and shape and fine chisel dressed on the sides to the full depth so that a straight edge laid along the side of the stone shall be in full contact with it. The sides (edges) shall be table rubbed with coarse sand or machine rubbed before paving. All angles and edges of the slabs shall be true, square and free from chippings and the surface shall be true and plane.

### **1.3 Preparation of Surface and Laying**

**1.3.1** Sub-grade concrete or the RCC slab which are laid for raising of floor at ground floor on which the kota stone slabs are to be laid shall be cleaned, wetted and mopped. The bedding for the slabs shall be with cement mortar and the thickness as indicated.

**1.3.2** The slabs shall be laid in the following manner:- Mortar of the specified mix shall be spread under the area of each slab, roughly to the average thickness as indicated. The slab shall be washed and cleaned before laying. It shall be laid on top, pressed, tapped with wooden mallet and brought to level with the adjoining slabs. It shall be lifted and laid aside. The top surface of the mortar shall then be corrected by adding fresh mortar at hollows. The mortar is allowed to harden a bit and cement slurry of honey like consistency shall be spread over the same at the rate of 4 kg of cement per square metre. The slab to be paved shall be lowered gently back in position bedded in level. Subsequent slabs shall be laid in the same manner and joints between adjacent slabs shall be as thin as possible and run in straight line. After each slab has been laid, surplus cement grout coming out of the joints of the slabs shall be cleaned off. The surface of the flooring as laid shall be true to levels, lines and shapes as instructed by the Engineer-in-Charge.

1.3.3 Slabs which are fixed in the floor adjoining the wall shall enter not less than twelve (12) mm under the plaster skirting or dado. The junction between wall plaster and the floor shall be finished neatly and without waviness.

#### 1.3.4 Curing, Polishing and Finishing

1.3.4.1 The floor shall be kept wet for a minimum period of seven (7) days. The surface shall thereafter be ground evenly with machine fitted with fine grade blocks (Minimum No. 60). The final grinding with machine fitted with the finest grade grit blocks (No. 320 or higher) shall be carried out the day after the first grinding described above or before handing over the floor, as ordered by the Engineer-in-Charge.

*(In brief After the Kota stone flooring work is cured, it shall be rubbed with carborundum stone of different grades no. 60, 120 and 320 in succession or with electrical rubbing machines rubbed with carborundum items 0 to 6 nos.in succession, to give a plane true and highly smooth surface)*

1.3.4.2 For small areas or where circumstances so require, hand polishing may be permitted in lieu of machine polishing after laying. For hand polishing the following Carborundum stones shall be used. 1st grinding - Medium Grade Stone (No.8) Final Grinding - Fine Grade (No.120 and 320)

1.3.4.3 In all other respects, the process shall be similar as for machine polishing.

1.3.4.4 After the final polish, oxalic acid shall be dusted over the surface at the rates of thirty three (33) gms. per square metre sprinkled with water and rubbed hard with pad of wooden rags. The following day the floor shall be wiped with a moist rag and dried with a soft cloth and finished clean.

1.3.4.5 If any slab is disturbed or damaged, it shall be refitted or replaced, properly jointed and polished. The finished floor shall not sound hollow when tapped with wooden mallet.

#### **KOTA STONE IN SKIRTING**

2.1 Kota Stone Slabs and Dressing shall be as specified above except that the thickness of the slabs shall be 12 mm or as specified in the description of the item. The slabs may be of uniform size, colour and shade.

2.2 Curing, Polishing and Finishing shall be as specified in aobe except that portable hand polishing machine may be used and except that first polishing with coarse grade carborundum stone shall not be done.

2.3 Measurements Length shall be measured along the finished face of skirting or dado correct to a cm. Height shall be measured from the finished level of floor to the top (the underside of tread in the case of steps). This shall be measured correct to a mm in the case of risers of steps and skirting and correct to a cm in the case of dado. The area shall be calculated in square metre correct to two places of decimal.

2.4 Rate The rate shall include the cost of all materials and labour, taxes, sundries, CPOH, Tools and Tackles etc. involved in all the operations described above.

## **Metal fabrication**

### **Material, fabrication and welding**

Providing and fixing MS structural Steel Work for the support system, platform, columns, roofing system etc. The welding of the members should be done in such a way to provide strong, distortion free surface. If found necessary, test for strength of the weld may be advised by the Bank to the vendor such as dye test, the cost of which will be borne by the vendor. MS members should be structurally Uniform, smooth on the surface, straight on the edges, uniform in the thickness and free from any defects. MS members should conform to the relevant IS codes. Welding should be done with the suitable welding electrodes (preferably E6013 or equivalent based on the properties of the base metal) after taking approval by the Bank for the make and type of electrode. The electrode should meet the criteria laid by the relevant IS codes. The MS members should strictly be fixed in line, level and proper alignment. This should be ensured and keep in mind by the bidder that no deviation in the line, level and alignment will be accepted by the Bank and any such work will be rejected by the Bank. This will be thoroughly checked and approved by the Bank and if there is any undulation was found, vendor need to remove and re-fix the non-aligned and its adjacent members so that after re-fixing, true line and level may be found. Welding work should be done by the skilled welder. For marking and cutting and hoisting of the MS sheet, skilled fitter should be employed by the vendor with all the necessary tools and tackles. All the marking, cutting, fabrication, welding, hoisting and finishing work should be done under proper supervision and ensuring safety of

workmen at site. Contractor need to depute a full-time supervisor for ensuring the progress, quality and safety of workmen. Proper PPE's should be provided to the workmen and staff during the Execution of work.

MS section (hollow or single section) needed for supporting, strengthening, covering the gap etc. will also to be in the scope of the contractor for which sperate items of work is taken and will be paid under this item of work.

Any damage to the existing masonry and MS steel portion of the nearby structures or area or fitting such as winows, stone cladding, etc. due to execution work; need to be rectified or in case if it seems irreparable, the vendor needs to replace free of cost with the new one with same specification and same make and brand. All the making of good to damages to the structures will be responsibility of the contractor.

#### Electricity and storage

Bank will provide the electricity at free of cost to the Vendor however he should make his own arrangement for drawing the power from the existing source of power supply to the work site like power cable of suitable length and capacity etc.

The materials should be stored at designated places which may be at any location inside the premises of the Bank.

#### Maintaining smoothness and avoiding thermal cracking

The MS sheets are to be welded on the existing MS grill made of MS flats, angles bars etc. which may not be in same plane and their alignment may got disturb during due to some factors. Necessary wedge and other arrangement need to be done by the vendor so that after fixing the MS sheets, the surface should be in true vertical plane and in line and level. Adjacent MS sheet should have continuous butt weld from top edge to bottom edge. To avoid distortion and buckling of the sheets at high temperatures, expansion gap of 3.00 mm must be given at every 20 feet or 6.00 meter or as per the instruction of the Engineer In charge considering the suitability of the site. Wherever needed, this gap of 3.00 mm should be covered from behind by welding the sheet of same thickness and minimum 12 mm wide up to full height of the parent sheet with the help of tack welding but ensuring the sufficient strength.

#### Wastage

Contractor should visit and site, assess the quantum of work, including the wastage material to meet the specifications of the work and quote his/her rate (inclusive GST accordingly). Contractor need to plan his work to minimize the wastage. No claim regarding non-consideration of the factors as per site conditions and technical specification will be entertained by the Bank.

#### Priming and painting

Work should be planned in such a way that, no part left without priming and each single surface which is exposed to environment can be primed. Welding work should be done prior to priming and after thorough cleaning the surface with wire brush and air blowing the surface to remove dust and dirt from the surface.

All the exposed surface of the MS members should be painted with minimum 2 coats of synthetic enamel paint (SEP) of approved brand and shade after 1 coat of priming and thorough cleaning of the surface. After successful completion of metal fabrication work and roofing working, the work shall be get checked and certified by the Bank for final painting work. **The cost of metal primer and Synthetic Enamel painting is included in the item of work. No Extra payment will be made for painting of MS structural steel work.**



## **uPVC Windows and door Work**

### **Composition of material, profile and its constructions**

The profiles shall be hollow, multi-chambered with outer wall thickness of  $2.3 \pm 0.2$  mm and metallic reinforcement. The profile depth should be of 60X 60 mm with a nominal wall thickness  $2.3 \pm 0.2$ , Profile shall be made up of Un-plasticized PVC (Polyvinyl Chloride) meeting the physical and chemical laid down and revised from time to time by by ASTM/ BS/ EN/ISO. No reworked material is to be used in any profile, whether used internally or externally. The internal drainage shall be isolated from chambers into which reinforcements can be placed or through which frame fixing pass. Drainage shall be either through the base or alternatively to the face, concealed by face drainage caps

### **Toughened Glass**

**Thickness of the glass for door shall be 10 mm for windows and 12 mm for door.**

**The glass shall be fixed to uPVC profile using glazing beads of appropriate size.**

**Process of Manufacture:** The glass plate is heated to a temperature above its softening point and then subjected to rapid cooling. The glass is suddenly chilled and in this process contracts towards the core. It stretches until it has solidified and is no longer able to contract further at this stage the core is still soft. It contracts against restrained exercise by the solidified upper layer of the glass. This compression is responsible for the strength of the glass sheet. Thus it is highly stressed and the resultant force is able to nullify the external impact. The intensity of the stresses depends on the rate of cooling, co-efficient of expansion, thermal conductivity of the glass, its specific heat, elasticity, and certain other physical properties.

**Toughening Process:** The raw plate glass sheet which is free from waviness, distortion etc., is cut to required size and shape and then all the edges are ground and polished as per end use of the product. This is called edge grinding and polishing and is very important for toughening because it will lead to breakages during process. No glass sheet can be toughened without edge grinding and polishing. Washing and Drying After the edge grinding and polishing the glass sheets are washed manually or by machine and then dried. The glass sheets are fed into the furnace (Electrically operated). The sheets are kept in the furnace above its softening point, which varies according to the composition of glass. After attaining required temperature the glass sheets are removed

out of the furnace and placed in the air blowing quenching boxes for 20 to 25 seconds. After quenching glass sheet is toughened. For bend glass toughening, the glass sheets pass through a set of dies (as per shape) after furnace and then to the quenching boxes. Testing After toughening all the sheet glasses are passed through the polariscope inspection.

#### **Approval of Samples, Handling of material:**

1. Submit manufacturer's standard size sample of sections of all size that are to be used to the work.
2. Submit samples that are large enough to exhibit the technical specifications color and other properties.
3. Deliver materials to site in original factory wrappings and containers, clearly labeled with identification of manufacturer, brand name,
4. Store materials in original undamaged packages and containers, inside well-ventilated area protected from weather, moisture, soiling, extreme temperatures, humidity; laid flat, blocked off ground to prevent sagging and warping.
5. Do not stack packages higher than recommended by manufacturer.

#### **Glazing beads**

Glazing beads shall be extruded U PVC mitred at the corners. All glazing beads shall be with a co-extruded gasket of a multi-fin design to maintain security and weather performance. Gasket material shall be thermo Plastic Elastomer.

#### **Glazing gaskets**

All glazing gaskets as well as weather seals are to be extruded from non-migratory EPDM. Glazing gaskets shall be a continuous length. Gasket may be subjected to random testing and shall be obtained from the profile Systems supplier.

#### **Reinforcement:**

All transoms and mullions shall be fully reinforced, irrespective of size, with corrosion resistant galvanized steel. All other profiles to be reinforced as per the specification of the profile Systems supplier which shall suit the proposed style application relative to exposure, elevation and height above the ground level. Reinforcing shall be secured by suitable screws in accordance with the instructions of the profile Systems supplier.

**Friction Stay hinges:**

The size of the **Friction Stay hinges** will depend on size, weight, hanging and exposure of the relevant sashes. This will be determined from table provided by the hinge manufacturer.

**Welded joints**

All corner joints shall be homogeneously fusion heat welded in accordance with the instructions of the profile Systems supplier. The resulting joints shall be finished by the grooving/knifing method. Solvent welded joints shall not be allowed

**Fixing the frame to the building**

The gap between the structural opening and the uPVC frame shall be between 5 to 10mm all round, which should be filled by injectable PU foam after completion of fixing for best frame and wall bonding, and for sound and thermal insulation and finally applying neutral cure low modulus Silicone sealant to make joint waterproof.

Fixing points shall be to all four sides of a frame, spaced 150mm to 250mm from corners and not more than 600mm apart elsewhere. Fixing shall be by direct drilling 10mm hole through U PVC frame to building wall. Each fixing shall penetrate building structure by no less than 40mm and ultimate fixing with anti-corrosive plated anchor bolts through these holes. All heads of all fixing screws shall be covered with appropriate plastic cover caps.

**Durability**

The Systems shall be resistant to chemicals and be fungal and vermin proof. The profiles must be colourfast, being able to withstand weather.

**Colour**

The Systems colour should be uniform and consistent.

**Fire resistance**

The UPVC should be classed as self-extinguishing to prevent support or enhancement of accidental fires.

**Quality control**

The extrusion process must be quality controlled and the appropriate standards relating to impact strength, technical performance and consistency.

**Warranty**

The window manufacturer shall issue to the client a certificate of warrantee against any manufacturing or installation defect, valid for minimum of five year for rectification of the defect.

### **Installation:**

1. Examine substrates/base surface for undulations and other conditions of the surface on which UPVC windows are to be installed. Notify Bank's Engineer in writing of conditions detrimental to proper completion of the work. Do not proceed until unsatisfactory conditions have been corrected.
2. Correct all the unfavorable substrate conditions such repair, levelling and cleaning as vacuum in place with industrial vacuum cleaner, levelling of base surface etc. up to satisfaction of the Bank's Engineer.
3. Field verify all dimensions and other work conditions affecting the installation of UPVC window.
4. Repair minor holes, cracks, depressions, or rough areas using Cement Mortar (1 cement: 3 Coarse sand)
5. Remove grease, oils, loose particles, paint, dirt, etc. and all other foreign substances. Clear away debris and scrape up cementitious deposits from surfaces for fixing of UPVC windows and vacuum clean immediately before installation.
6. Coordinate UPVC windows installation with any other ongoing work like electrical/telephone/data/ interior work so that work can be completed smoothly.
7. Sequence UPVC windows installation with other work to minimize possibility of damage of material during remainder of renovation period.

### **Removal of the existing MS windows/glazing/handles and repair of sill, lintel and jamb in line and level:**

1. The existing MS windows/glazing and handles shall be carefully removed only after all the fittings and furniture has been cleared from the site.
2. Existing window/door frame shall be carefully cut and removed without causing major damage to the sill, lintel and jamb. Minor damages caused need to be repaired by the contractor in line and level.
3. The existing MS windows/door along with glazing and handles shall be removed carefully to receive the base surface without causing any damage to the surroundings.
4. Repair of sill, lintel and jamb in line and level with cement mortar 1:3 (1 cement and 3 coarse sand)

5. Any damages caused to any other surfaces during the removal process shall be re-instated by the Contractor at no additional cost to the Employer.
6. The contractor shall maintain/ disconnect existing services, whether temporary or permanent, where required by the Engineer-in-Charge
7. The removed window shall be properly stacked for handling until removed from the premises as per the instructions of the Engineer-in-charge.
8. All the stacked un-usable materials shall be cleared from the premises and disposed in a proper manner as and when instructed by Engineer-in-Charge.
9. Dismantled glass shall be disposed off immediately from the premises.

### **Double scaffolding (Steel)**

A temporary erection of steel work used in the construction, alteration, demolition or Repairs, cleaning and coating including external painting work of a building to support or to attend of the hoisting or lowering of workmen, their tools and materials. Scaffoldings are of two types, namely single and double scaffoldings. Single scaffolding consists of a row of verticals connected to wall by horizontal supported on and tied to the structure. Double scaffolding consists of two rows of verticals secured or leashed together with horizontal and diagonal bracings forming essentially a structure independent of the building. It may also connect to the structure at convenient points for the sake of better stability.

Only double scaffolding of steel member (as specified below) is allowed for the works mentioned in the tender.

### **DOUBLE SCAFFOLDING SYSTEM MADE WITH MS TUBE**

Scaffolding shall be strong to withstand all dead, live and impact loads which are likely to come on them. Scaffolding shall be provided to allow easy approach to every part of the work. The double scaffolding made with 40mm dia and 25mm dia pipe shall be erected along the wall surface. The MS pipe of heavy duty with wall thickness 4mm shall be used for the scaffolding. The scaffolding shall be erected in double row system and at every 9m height the extra 1 row of 40mm dia pipe perpendicular to wall surface shall be provided to secure the both layer of vertical pipe in the wall for better stability. It should be strong enough to with stand all coming load / wind pressure/tilt etc. The

double scaffolding consists of 2 rows of vertical with horizontal and diagonal bracing forming essentially a structure independent of the building. The bottom of the scaffolding shall be fixed in suitable MS chair on base plate of minimum 12mm thick and 25x25cm size. The plate should be properly placed firm plate concrete floor. The frame work of scaffolding made with 40mm dia MS tube 1.5m centre to centre horizontal and vertical joint with cup and lock system and MS fixtures etc. MS tube chalis and MS tube staircase in scaffolding for working platform etc. shall also be provided. The scaffolding system shall be stiffened with bracings, runners, connection with the building etc. wherever required for inspection of work at required locations with essential safety features for the workman etc. complete as per directions and approval of Engineer-in-charge.

Double scaffolding with without cup and lock i.e with clamp may only be allowed in exceptional cases with prior permission of the Bank.

Typical layout of Double scaffolding system made with MS tube

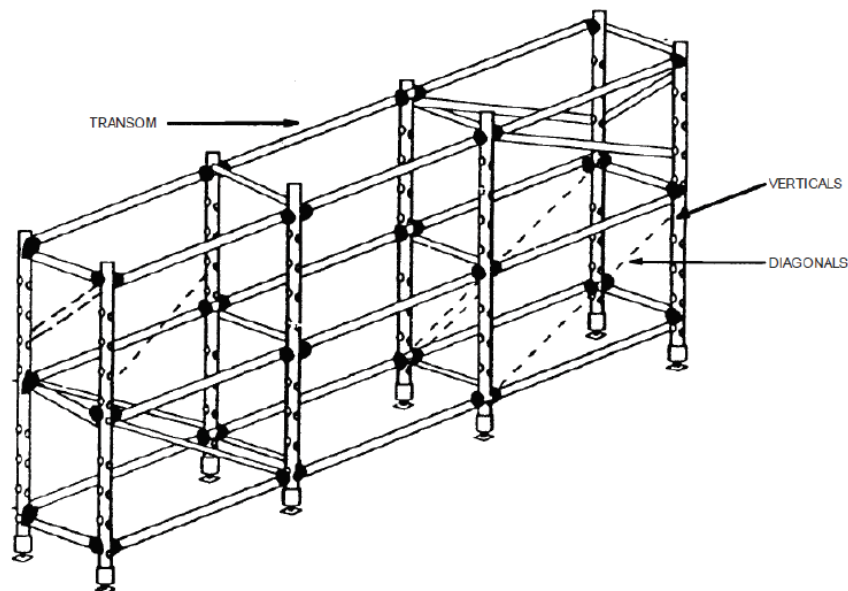

All Members are of Steel

Note:-

- 1) The condition of MS tube and required claddings should be in good condition and should not have been used more than the specified time/nos. Scaffolding system shall remain the property of the contractor after completion of work.
- 2) This item to be used for Repair/maintenance/erection/renovation work for the entire period of contract till the completion of all the items of work.
- 3) Scaffolding to be erected along the façade of the building in curvilinear portion (i.e. along the curvature and linear portion of the building) and no extra payment will be made for erecting the scaffolding along the curvature of the Building)
- 4) The elevational area (Height will be taken from top of floor to the top of scaffolding) of the scaffolding shall be measured for payment purpose. For measurement purpose, maximum height will be taken from the floor/surface where scaffolding is supported; to the top of scaffolding (if scaffolding is continuous from floor/surface to parapet top or higher). However, vendor need to raise the height of scaffolding higher than the top to facilitate the working and to provide the safety of the workmen.
- 5) The payment will be made once only for execution of all items for such works.
- 6) The staging area of additional Tubular Frames for supporting double scaffolding system, if required shall not be measured for payment purpose.
- 7) Suitable nylon of adequate strength nylon net around the working area of the building including curtain covering shall be fixed to catch any falling objects and for safety of workmen. No extra Payment will be made for P/F of Nylon Net and is including in this item of work.
- 8) Scaffolding shall be measured once only and the same shall be maintained till the work is completed.
- 9) The contractor has to observe all safety procedure while working on heights as per IS 3696 (Part-I)1987.
- 10) Labors working on the scaffolding should be provided with safety belts, helmets and they should wear the same while working.

## **ALUMINIUM COMPOSITE PANELS (ACP) CLADDING**

### **Aluminium extrusions**

In general, aluminium alloy for extrusions shall be 6063 T5 or T6 grade as per B.S.1474. However, the grade and tempering specifications shall be as recommended by the supplier for each application.

All extruded aluminium sections shall be 3.00 mm thick with PVDF coil / spray coated in approved colour and shade with metallic/Wooden colours and texture. The colour and the finish shall be uniform and free of streaks. The aluminium sections, before coating, shall be suitably cleaned, rinsed, buffed properly and sealed and protected after anodizing / PVDF coating, till the completion of the work.

1. All composite aluminum panels shall have a thickness of 3.00mm.
2. The composite cladding panels shall be framed with an extrude aluminum profile as mentioned in BOQ
3. All fasteners shall be concealed within the panel joints. All fixing and joint details shall be designed to provide for the expected thermal expansion and contraction. The fixing of these panels shall accommodate the expected structural movements in the building.
4. With a gloss of 30% according to Gardner Scale, the installed composite panel surface shall not have irregularities such as oil canning, waves, buckles, and other irregularities when viewed at any position not less than 15 degrees to the true plane of the panel.
5. All fasteners, anchors, brackets and similar attachments used for the fixing and erection of these panels shall be of aluminum, non-magnetic stainless steel, or hot dip galvanized steel.

### **Electricity and storage**

Bank will provide the electricity at free of cost to the Vendor however contractor should make his own arrangement for drawing the power from the existing source of power supply to the work site like power cable of suitable length and capacity etc. The materials should be stored at designated places which may be at any location inside the premises of the Bank.



**Wastage**

The vendor should visit the site and understand the quantum of work, including the wastage material to meet the specifications of the work, labor part for making the desired layout in the windows work and quote his/her rate (inclusive GST) accordingly. Contractors need to plan his work to minimize the wastage. No claim regarding non-consideration of the factors as per site conditions and technical specification will be entertained by the Bank.

**Signature of Tenderer :****Date:****Name & address**

**Plan showing proposed area after Renovation**

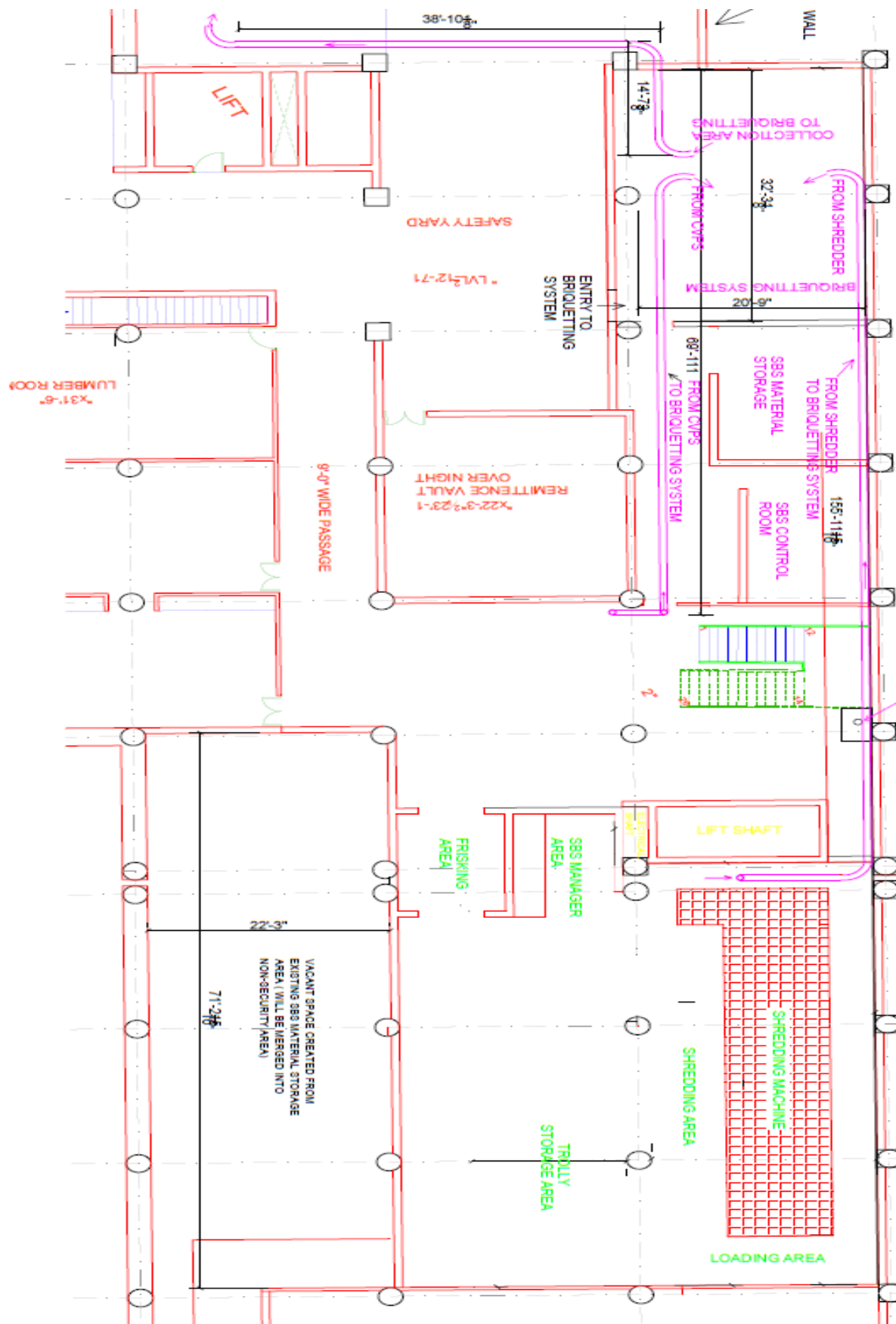

**SAFETY CODE**

1. There shall be maintained in a readily accessible place first aid appliance including adequate supply of sterilized dressings and cotton wool. An injured person shall be taken to a public hospital without loss of time, in cases where the injury necessitates hospitalization.
2. Suitable and strong scaffolds should be provided for workmen for all work that cannot safely be done from ground.
3. No portable single ladder shall be over 8 meters in length. The width between the side rails shall not be less than 30 cm. (clear) and the distance between two adjacent rungs shall not be more than 30 cm. When a ladder is used an extra labour shall be engaged for holding the ladder.
4. Every opening in the floor of a building or in a working platform shall be provided with suitable means to prevent the fall of persons or materials by providing suitable fencing or railing; minimum height shall be one meter.
5. No floor, roof or other part of the structure shall be so overloaded with debris of materials as to render it unsafe.
6. Workers employed on mixing and handling material such as asphalt, cement mortar or concrete shall be provided with protective footwear and rubber hand-gloves.
7. Those engaged in welding works shall be provided with welder's protective eye-shields and gloves.
8. No paint containing lead or lead products shall be used except in the forms of paste or readymade paint.
9. Suitable face masks shall be supplied for use by the workers when the paint is applied in the form of spray or surface having lead paint dry rubbed and scrapped. Overalls shall be supplied by the Contractor to the painters and adequate facilities shall be provided to enable the working painters to wash during the period of cessation of work.
10. Hoisting machines and tackle used in the works, including their attachments, anchorage and support shall be in perfect condition.
11. The ropes used in hoisting or lowering material, or a means of suspension shall be of durable quality and adequate strength and free from defects.

Place:

Signature of Contractor with Seal

Name &amp; Address

Date:

**FIRE SAFETY CODE**

- a) Cutting / drilling machine and other electrically operated equipment used at site shall be plugged into correctly rated electrical outlets.
- b) Only ISI marked 3-pin plug and other appliances and equipment shall be used.
- c) Electrical power cables/wires used shall not have any joints and shall be properly rated.
- d) All electrical appliances, i.e., welding, drilling, cutting machine etc. shall be safely and securely earthed to prevent leakage current while in operation.
- e) Two buckets of water and sand shall be kept in an easily accessible area on the site.
- f) Fire extinguishers recommended shall be kept on the site. Used paint drums shall be stored in specified store only after closing them properly.
- g) Personal protective equipment such as safety shoes, hand gloves, welder's mask, ear plug etc. depending upon the requirement of the work shall be provided by the contractor to the workmen to prevent occupational health hazards.
- h) The safety belt shall be provided by the contractor and used by the workmen while working from height for more than 10 feet from Ground level.
- i) None of the passages near lift lobby and staircases lobby shall be used for stacking / dumping any kind of materials/waste.
- j) None of the fire extinguishers shall be removed/shifted from its designated location.
- k) Power supply shall be switched off from the mains when equipment is not in use.
- l) Any debris generated from the work shall be collected on daily basis, removed from site and stored at the designated place in proper manner.

Place:  
Date:

Signature of the tenderer:  
Address:

### **Important instructions regarding e-tender**

This is an e-procurement event of Reserve Bank of India, CHANDIGARH. The e-procurement service provider is MSTC Limited.

You are requested to read and understand the Notice Inviting E-Tender and subsequent Corrigendum, if any, before submitting your online tender. Tenderers who do not comply with the conditions with documentary proof (wherever required) will not qualify in the Tender for opening of price bid.

1.	<p><b>Process of E-tender:</b></p> <p><b>A) Registration:</b> The process involves vendor's registration with MSTC e-procurement portal which is free of cost. Only after registration, the vendor(s) can submit his/their bids electronically. Electronic Bidding for submission of Techno-Commercial Bid as well as Price Bid over the internet will be done. The Vendor should possess Class III signing type digital certificate. Vendors are to make their own arrangement for bidding from a P.C. connected with Internet. MSTC/RBI, CHANDIGARH is not responsible for making such arrangement. (Bids will not be recorded without Digital Signature).</p> <p><b>SPECIAL NOTE: THE PRICE BID AND THE COMMERCIAL BID HAS TO BE SUBMITTED ON-LINE ONLY AT <a href="http://www.mstcecommerce.com/eprocn/">www.mstcecommerce.com/eprocn/</a></b></p> <p>1). Vendors are required to register themselves online with <a href="http://www.mstcecommerce.com">www.mstcecommerce.com</a> → e-Procurement → PSU /govt depts → RBI CHANDIGARH → Register as Vendor Filling up details and creating own user id and password → Submit.</p> <p>2). Vendors will receive a system generated mail confirming their registration in their email which has been provided while filling the registration form.</p> <p>In case of any clarification, please contact MSTC/RBI, CHANDIGARH, (before the scheduled time of the e-tender).</p> <p><b>B) System Requirement:</b></p> <p>i) Windows XP-SP3 &amp; above/Windows 7 Operating System</p> <p>ii) IE-7 and above Internet browser.</p> <p>iii) Signing type digital signature</p> <p>iv) JRE 7 update 9 and above software to be downloaded and installed in the system.</p> <p>To enable ALL active X controls and disable 'use pop up blocker' under Tools → Internet Options → custom level</p>
----	---

	For more details, vendor may refer to the <b>Vendor Guide</b> and <b>FAQ</b> available at <a href="http://www.mstcecommerce.com/eprocn/">www.mstcecommerce.com/eprocn/</a> .
2.	<p>(A) Part I Techno-Commercial bid will be opened electronically on specified date and time as given in the NIT.</p> <p>(B) Part II Price bid will be opened electronically of only those bidder(s) whose Part I Techno-Commercial Bid is found to be Techno-Commercially acceptable by RBI, CHANDIGARH. Such bidder(s) will be intimated date of opening of Part II Price bid, through valid email confirmed by them.</p> <p><b>Note:</b></p> <p>The tenderers are advised to offer their best possible rates. There would generally be no negotiations hence please submit your most competitive prices while submitting the price bid. However in case the lowest rate appears to be reasonable taking into account the prevailing market conditions, the order may be awarded to the lowest bidder and if the rate is still considered high, action as per prevailing instruction/guideline shall be taken.</p>
3.	All entries in the e-Tender should be entered in online Technical & Commercial Formats without any ambiguity.
4.	<p><b><u>Special Note towards Transaction fee:</u></b> PAYMENT OF Transaction fee is online on MSTC site</p> <p>After making the payment for transaction fee, the vendor should enter the transaction fee details by using the "Transaction Fee entry" Link under "My Menu" in the vendor login. Here the vendor may select the particular e-Tender in which they want to participate by clicking on the tick box at the right and then Clicking on the "Submit" Button at the bottom Of the page. Then the page appears where the vendors are required to fill up the transaction details, namely the UTR No, Date Of Transaction, And the Remitting Bank in the given fields and then clicking on the "Confirm" Button.</p> <p><b>NOTE :</b> The bidders should submit the transaction fee well in advance before the last date of submission of e-Tender as they will be activated for bid submission only after receipt of transaction fee by MSTC.</p> <p>Vendors are advised not to deposit cash in bank as it becomes difficult to ascertain the details of the remitter from such cash transactions.</p> <p>Bidders may please note that the transaction fee should be deposited by debiting the account of the bidder only; transaction fee deposited from or by debiting any other party's account will not be accepted. <b>Transaction fee is non-refundable.</b></p> <p>In case of failure to make payment towards Transaction fee for any reason, the vendor, in term, will not have the access to online e-tender.</p>

5.	<p>Vendors are instructed to use <b>Upload Documents</b> link in My menu to upload documents in document library. Multiple documents can be uploaded. Maximum size of single document for upload is 5 MB.</p> <p>Once documents are uploaded in the library, vendors can attach documents through <b>Attach Document</b> link against the particular e-Tender. Please note that if the documents are not attached to any e-Tender, the same cannot be downloaded by RBI CHANDIGARH and it will be deemed that the vendor has not submitted the documents. For further assistance please follow instructions of vendor guide.</p>
6.	<p>All notices and correspondence to the bidder(s) shall be sent by email only during the process till finalization of e-Tender by RBI, CHANDIGARH as well as by MSTC (e-procurement service provider). Hence the bidders are required to ensure that their email address provided is valid and updated at the stage of registration of vendor with MSTC (i.e. Service Provider). Bidders are also requested to ensure validity of their DSC (Digital Signature Certificate).</p>
7.	<p>(i) Please note that there is no provision to take out the list of parties downloading the e-Tender document from the web site mentioned in NIT. As such, bidders are requested to see the web site once again before the due date of e-Tender opening to ensure that they have not missed any corrigendum uploaded against the said e-Tender after downloading the e-Tender document. <b>The responsibility of downloading the related corrigenda, if any, will be of the bidders only.</b></p> <p>(ii) No separate intimation in respect of corrigendum to this NIT (if any) will be sent to tenderer (s) who have downloaded the documents from web site. Please see website <a href="http://www.mstcecommerce.com/eprochome/rbind">www.mstcecommerce.com/eprochome/rbind</a> of MSTC Ltd.</p>
8	<p>E-tender cannot be accessed after the due date and time mentioned in NIT.</p>
9.	<p><b><u>Bidding in e-tender</u></b></p> <p>a) Bidder(s) need to submit necessary EMD, E-Tender fees (If ANY) and Transaction separately for the e-tender. Transaction fees if any are non-refundable. No interest will be paid on EMD. EMD of the unsuccessful bidder(s) will be refunded by RBI, CHANDIGARH.</p> <p>b) The process involves Electronic Bidding for submission of Techno Commercial Bid as well as Price Bid.</p> <p>c) The bidder(s) who have submitted the above fees can only submit their Techno Commercial Bids and Price Bid through internet in MSTC website <a href="http://www.mstcecommerce.com">www.mstcecommerce.com</a> → e-procurement → PSU /Government Departments → RBI CHANDIGARH Login → My menu → Auction Floor Manager → live event → Selection of the live event → Techno Commercial Bid.</p> <p>d) The bidder should allow to run an application namely en Apple by accepting the risk and clicking on run. This exercise has to be done twice immediately</p>

	<p>after reaching the bid floor. If this application is not run then the bidder will not be able to save/submit his bid.(for details refer vendor guide &amp; FAQ).</p> <p>e) First the vendor needs to fill up the Commercial specification if any and save it. Then the vendor should fill up the Techno-commercial bid. After filling the Techno-Commercial Bid, bidder should click 'save' for recording their Techno-Commercial bid. Once the same is done, the Price Bid link becomes active and the same has to filled up and then bidder should click on "save" to record their price bid. Then once both the Techno-Commercial bid &amp; price bid has been saved, the bidder can click on the "Final Submission" button to register their bid</p> <p><b>NOTE:</b> - After clicking the final submission two more options will show up, "Withdraw bid" and "Delete bid". If the vendor wants to withdraw its bid permanently then they should click withdraw bid link. He/she will not be able to bid again. If the vendor wants to delete the bid after final submission and re submit the bid then he/she should click delete bid and resubmit the same and again click final submission.</p> <p>f) In all cases, bidder should use their own ID and Password along with Digital Signature at the time of submission of their bid.</p> <p>g) During the entire e-tender process, the bidders will remain completely anonymous to one another and also to everybody else.</p> <p>h) The e-tender floor shall remain open from the pre-announced date &amp; time and for as much duration as mentioned above.</p> <p>i) All electronic bids submitted during the e-tender process shall be legally binding on the bidder. Any bid will be considered as the valid bid offered by that bidder and acceptance of the same by the Buyer will form a binding contract between Buyer and the Bidder for execution of supply/work. Such successful tenderer shall be called hereafter <b>SUPPLIER/CONTRACTOR</b>.</p> <p>j) It is mandatory that all the bids are submitted with digital signature certificate otherwise the same will not be accepted by the system.</p> <p>k) Buyer reserves the right to cancel or reject or accept or withdraw or extend the tender in full or part as the case may be without assigning any reason thereof.</p> <p>l) No deviation of the terms and conditions of the e-Tender document is acceptable. Submission of bid in the e-tender floor by any bidder confirms his acceptance of terms &amp; conditions for the e-Tender.</p> <p>m) Unit of Measure (UOM) is indicated in the e-tender Floor. Rate to be quoted should be in Indian Rupee as per UOM indicated in the e-tender floor/tender document.</p>
10.	Any order resulting from this open e-tender shall be governed by the terms and conditions mentioned therein.



11.	No deviation to the technical and commercial terms & conditions are allowed.
12.	RBI, CHANDIGARH has the right to cancel this e-tender or extend the due date of receipt of bid(s) without assigning any reason thereof.
13	The online e-Tender should be submitted strictly as per the terms and conditions and procedures laid down in the website <a href="http://www.mstcecommerce.com/eprochome/rbind">www.mstcecommerce.com/eprochome/rbind</a> of MSTC Ltd.
14.	The bidders must upload all the documents required as per terms of NIT. Any other document uploaded which is not required as per the terms of the NIT shall not be considered.
15	The bid will be evaluated based on the filled-in technical & commercial formats.
16.	The documents uploaded by bidder(s) will be scrutinized. In case any of the information furnished by the bidder is found to be false during scrutiny, EMD of defaulting bidder(s) will be forfeited. Punitive action including suspension and banning of business can also be taken against defaulting bidders.

## **Annexure II- Draft Articles of Agreement**

(for successful bidder only)  
(On the ₹100/- stamp paper)

यह करार वर्ष \_\_\_\_\_ के माह \_\_\_\_\_ के \_\_\_\_\_ वें दिन एक पक्ष के तौर पर क्षेत्रीय निदेशक, संपदा विभाग, भारतीय रिज़र्व बैंक, चंडीगढ़- 160017 (जिसे इसके बाद "नियोक्ता" कहा गया है (और दूसरे पक्ष \_\_\_\_\_ (जिन्हें इसके बाद "संविदाकर्ता" कहा गया है) के बीच निष्पादित किया गया।

ARTICLES OF AGREEMENT made the \_\_\_\_\_ day of \_\_\_\_\_ between the Reserve Bank of India, Regional Director, Reserve Bank of India, Estate Department, Chandigarh – 160017, (hereinafter called "the Employer") of the one part and \_\_\_\_\_ (hereinafter called "the Contractor") of the other part.

जबकि नियोक्ता "भारतीय रिज़र्व बैंक, सेक्टर-17ए चंडीगढ़ के मुख्य कार्यालय भवन में नई एसबीएस (SBS) मशीनों की स्थापना के लिए नकदी क्षेत्र के नवीनीकरण" के कार्य कराने का इच्छुक है और रेखाचित्र एवं विनिर्देश तैयार किए हैं जिसमें किए जाने वाले कार्यों का उल्लेख है।

WHEREAS the Employer is desirous of carrying out the work of "**Renovation of Cash Area for Installation of New SBS Machines at Main Office Building of Reserve Bank of India, Sector- 17A, Chandigarh**" and has caused drawings and specifications describing the works to be done.

और उक्त विशिष्टताओं के अनुसार, मात्रा और रेखाचित्रों की अनुसूची पर या पार्टियों की ओर से हस्ताक्षर किए गए हैं।

AND WHEREAS the said specifications, the Schedule of Quantities and drawings have been signed by or on behalf of the parties hereto.

और यतः ठेकेदार ने इसके आगे उल्लिखित शर्तों तथा परिणाम की अनुसूची तथा ठेके की शर्तें (जिन्हे) इसके आगे सामग्री रूप से "उक्त शर्तें" कहा गया है) के अधीन उक्त आरेखनों में दर्शाये गए और/या उक्त विनिर्देशों में वर्णित तथा परिणाम की अनुसूची में सम्मिलित निर्माण कार्य को उनमें निर्दिष्ट दरों के अनुसार हिसाब लगाई गयी कुल राशि पर या ऐसी अन्य राशि पर, जो उनके अधीन देय हो (जिसे इसके आगे "उक्त ठेके की राशि" कहा गया है) निष्पादित करना स्वीकार किया है।

AND WHEREAS the Contractor has agreed to execute upon the subject to the Conditions set forth herein and to the Conditions set forth in the Special Conditions and in the Schedule of Quantities and Conditions of Contract (all of which are collectively hereinafter referred to as "the said Conditions") the works shown upon the said drawings and/or described in the said specification and included in the Schedule of Quantities at the respective rates therein set forth amounting to the sum as therein arrived at or such other sum as shall become payable thereunder (hereinafter referred to as 'the said Contract Amount')

अब इस बात पर निम्न तरह से सहमति है: <b>NOW IT IS HEREBY AGREED AS FOLLOWS:</b>	
1	<p>उक्त शर्तों में निर्दिष्ट अवधियों में और प्रणाली से देय ठेके की राशि के बदले ठेकेदार उक्त शर्तों पर तथा उनके अधीन और उक्त आरेखनों में दर्शित तथा उक्त विनिर्देशों एवं परिमाणों की अनुसूची में उल्लिखित निर्माण कार्य निष्पादित करेगा और पूरा करेगा।</p> <p>In consideration of said Contract Amount to be paid at the times and in the manner set forth in the said conditions, the Contractor shall upon and subject to the said Conditions execute and complete the work shown upon the said Drawings and</p>

	described in the said Drawings and described in the said Specifications and the Schedule of Quantities.
2	<p>बैंक ठेकेदार को उक्त शर्तों में निर्दिष्ट अवधियों में तथा उनमें निर्दिष्ट प्रणाली से उक्त ठेके की राशि या ऐसी कोई अन्य राशि, जो देय हो जाए अदा करेगा।</p> <p>The Bank shall pay the Contractor the said Contract Amount, or such other sum as shall become payable, at the times and in the manner specified in the said conditions.</p>
3	<p>उक्त शर्तों को और उनके परिशिष्ट को इस करार के भाग के साथ पढ़ा जाएगा तथा इस करार से संबन्धित पक्ष उक्त शर्तों का क्रपशः पालन करेंगे, अपने-आपको उनके अधीन मानेंगे तथा उसमें उल्लिखित शर्तों के अधीन अपनी और से करार का निष्पादन करेंगे।</p> <p>The said Conditions and Appendix thereto shall be read and construed as forming part of this agreement and the parties hereto shall respectively abide by, submit themselves to the said Conditions and perform the agreements on their part respectively in the said Conditions contained.</p>
4	<p>इसमें उल्लिखित नक्शे, करार और प्रलेख इस संविदा के आधार माने जायेंगे।</p> <p>The plans, agreement and documents mentioned herein shall form the basis of this Contract.</p>
5	<p>यह संविदा न तो निर्धारित एकमुश्त राशि की संविदा है और न ही फूटकर कार्य की संविदा, परंतु यह सम्पूर्ण "भारतीय रिज़र्व बैंक, सेक्टर-17ए चंडीगढ़ के मुख्य कार्यालय भवन में नई एसबीएस (SBS) मशीनों की स्थापना के लिए नकदी क्षेत्र के नवीनीकरण" के संबंध में कार्य को पूरा करने की संविदा है जिसके लिए दरों की अनुसूची तथा संभाव्य परिमाणों में उल्लिखित दरों पर या उक्त शर्तों में निर्दिष्ट दरों पर वस्तुतः हिसाब लगायी गयी मात्राओं के अनुसार अदायगी की जाएगी।</p> <p>This Contract is neither a fixed/ Lump sum Contract nor a Piece work Contract but is a Contract to carry out the "<b>Renovation of Cash Area for Installation of New SBS Machines at Main Office Building of Reserve Bank of India, Sector- 17A, Chandigarh</b>" to be paid for according to actual measured quantities at the rates contained in the Schedule of Rates and Probable quantities or as provided in the said Conditions.</p>
6	<p>अनुबंध में दिये अनुसार ठेकेदार को सिविल संबंधी सभी कार्यों हेतु वाजिब सुविधा वहन करनी होगी एवं ऐसे कार्यों के पूरा होने के बाद दीवारों, फर्श आदि को हुये नुकसान को ठीक करना होगा।</p> <p>The Contractor shall afford every reasonable facility for the carrying out of all works relating to civil works and other ancillary works in the manner laid down in the said Conditions, and shall make good any damages done to walls, floors etc. after the completion of such works.</p>
7	<p>बैंक इस अनुबंध में बिना किसी पूर्वाग्रह के किए जानेवाले कार्य में किसी भी मद को जोड़ने या हटाने एवं ड्रॉइंग और कार्य की प्रकृति को बदलने का अधिकार रखता है।</p> <p>The Bank reserves to itself the right of altering the Drawings and nature of the work by adding to or omitting any items of work or having portions of the same carried out without prejudice to this contract.</p>
8	<p>समय को इस अनुबंध के महत्वपूर्ण कारक के रूप में माना जाएगा, और ठेकेदार साइट को सौंपने के तुरंत बाद या औपचारिक कार्य आदेश जारी होने के 14वें दिनों के बाद जो भी बाद में हो दी गई शर्तों</p>

	<p>एवं समय विस्तार के प्रावधानों के अनुसार दी गई शर्तों के अनुसार कार्य पूर्ण करेगा एवं समय विस्तार के प्रावधानों के अधीन है।</p> <p>Time shall be considered as one of the important factors of this Contract, and the Contractor hereby agrees to commence the work soon after the site is handed over to him or from 14<sup>th</sup> day after the day of issue of formal works order as provided for in the said Conditions, whichever is later, and to complete the entire work as provided in said condition, subject nevertheless to the provisions for extension of time.</p>
9	<p>इस अनुबंध के तहत बैंक द्वारा सभी भुगतान केवल चंडीगढ़ में किए जाएंगे। All payments by the Bank under this Contract will be made only at Chandigarh.</p>
10	<p>इस समझौते से जुड़े या किसी भी तरह से उत्पन्न होने वाले सभी विवादों को चंडीगढ़ में उत्पन्न माना जाएगा और इनका निपटान केवल चंडीगढ़ में न्यायालयों के ही अधिकार क्षेत्र में होगा। All disputes arising out of or in any way connected with this agreement shall be deemed to have arisen at Chandigarh and only Courts in Chandigarh shall have jurisdiction to determine the same.</p>
11	<p>इस संविदा के विभिन्न अंशों को ठेकेदार ने पढ़ लिया है तथा उन्हें पूर्ण रूप से समझ लिया है। That the several parts of this Contract have been read by the Contractor and fully understood by the Contractor.</p>
12	<p><b>गैर-प्रकटीकरण खंड:</b> ठेकेदार, बैंक के बुनियादी ढांचे/प्रणालियों/उपकरणों आदि की प्रत्यक्ष या अप्रत्यक्ष रूप से किसी भी जानकारी, सामग्री और विवरण का किसी तीसरे पक्ष को खुलासा नहीं करेगा, जो इस समझौते के संबंध में अपने संविदात्मक दायित्वों के निर्वहन के दौरान ठेकेदार के कब्जे या ज्ञान के पास आ सकता है, और हर समय इस पर विश्वास रखेगा। ठेकेदार सिवाय इसके तहत दायित्वों को पूरा करने या लागू कानूनों का पालन करने के लिए आवश्यक सीमा के अलावा अनुबंध के विवरण को वैयक्त और गोपनीय मानेगा। ठेकेदार नियोक्ता की पिछली लिखित सहमति के बिना किसी भी व्यापार या तकनीकी पत्र या अन्य जगहों पर कार्यों के किसी भी विवरण का खुलासा, प्रकाशित होने की अनुमति नहीं देगा। ठेकेदार किसी भी गोपनीय जानकारी के प्रकटीकरण के परिणामस्वरूप नियोक्ता को होने वाले किसी भी नुकसान के लिए नियोक्ता को क्षतिपूर्ति करेगा। उपर्युक्त का पालन करने में विफलता को ठेकेदार की ओर से अनुबंध का उल्लंघन माना जाएगा और नियोक्ता नुकसान का दावा करने और कानूनी उपचारों को आगे बढ़ाने का हकदार होगा। ठेकेदार अपने कर्मचारियों के मध्य सभी उचित कार्रवाई करेगा ताकि यह सुनिश्चित किया जा सके कि इस समझौते के तहत गोपनीय सूचनाओं का प्रकटीकरण न करने के दायित्व पूरी तरह से संतुष्ट हों। गैर-प्रकटीकरण और गोपनीयता के संबंध में ठेकेदार के दायित्व किसी भी कारण से इस समझौते की समाप्ति या इस समझौते के टर्मिनेशन के बाद भी बने रहेंगे।</p> <p><b>Non-Disclosure clause:</b> The Contractor shall not disclose directly or indirectly any information, materials and details of the Bank's infrastructure/systems/equipment etc., which may come to the possession or knowledge of the Contractor during the course of discharging its contractual obligations in connection with this agreement, to any third party and shall at all times hold the same in strictest confidence. The Contractor shall treat the details of the contract as private and confidential, except to the extent necessary to carry out the obligations under it or to comply with applicable laws. The Contractor shall not publish, permit to be published, or disclose any particulars of the works in any trade or technical paper or elsewhere without the previous written consent of the Employer. The Contractor shall indemnify the</p>

	<p>Employer for any loss suffered by the Employer as a result of disclosure of any confidential information. Failure to observe the above shall be treated as breach of contract on the part of the Contractor and the Employer shall be entitled to claim damages and pursue legal remedies. The Contractor shall take all appropriate actions with respect to its employees to ensure that the obligations of non-disclosure of confidential information under this agreement are fully satisfied. The Contractor's obligations with respect to non-disclosure and confidentiality will survive even after the expiry or termination of this agreement for whatever reason.</p>
13	<p><b>यौन उत्पीड़न की रोकथाम संबंधी उपबंध / Prevention of Sexual harassment clause</b></p> <p>ठेकेदार / एजेंसी कार्य स्थल (रोकथाम, निषेध और निवारण) अधिनियम 2013 में महिलाओं के यौन उत्पीड़न के प्रावधान के पूर्ण अनुपालन के लिए पूरी तरह जिम्मेदार होगी। बैंक के परिसर के भीतर अपने कर्मचारी के खिलाफ यौन उत्पीड़न की किसी भी शिकायत के मामले में ठेकेदार / एजेंसी द्वारा गठित आंतरिक शिकायत समिति के समक्ष शिकायत दर्ज की जाएगी और ठेकेदार/एजेंसी शिकायत के संबंध में उक्त अधिनियम के तहत उचित कार्रवाई सुनिश्चित करेगी। बैंक के किसी भी कर्मचारी के खिलाफ ठेकेदार के किसी भी गंभीर कर्मचारी से यौन उत्पीड़न की किसी भी शिकायत का बैंक द्वारा गठित क्षेत्रीय शिकायत समिति द्वारा संज्ञान लिया जाएगा। यदि ठेकेदार के कर्मचारी द्वारा यौन हिंसा साबित हो जाती है, तो ठेकेदार किसी भी मौद्रिक मुआवजे के लिए जिम्मेदार होगा, जिसे घटना में कर्मचारी शामिल होने की स्थिति में भुगतान करने की आवश्यकता हो सकती है। ठेकेदार अपने कर्मचारी को कार्यस्थल पर यौन उत्पीड़न की रोकथाम और संबंधित मुद्दे के बारे में शिक्षित करने के लिए जिम्मेदार होगा।</p> <p>The Contractor / Agency shall be solely responsible for full compliance with the provision of "the sexual Harassment of women at workplace (Prevention, Prohibition and Redressal) Act 2013". In case of any complaint of sexual harassment against its employee within the premises of Bank, complaint will be filed before the Internal complaint committee constituted by the Contractor / Agency and the Contractor / Agency shall ensure appropriate action under the said Act in respect to the complaint. Any complaint of sexual harassment from any aggravated employee of the contractor against any employee of the Bank shall be taken cognizance of by the Regional Complaints Committee constituted by the Bank. The Contractor shall be responsible for any monetary compensation that may need to be paid in case the incident involves the employee, if sexual violence by the employee of the contractor is proved. The contractor shall be responsible for educating its employee about prevention of sexual harassment at workplace and related issue.</p>
14	<p>संविदाकार निम्न के संबंध में भारतीय रिजर्व बैंक के पक्ष में बीमा करवाएगा/संबन्धित दस्तावेज़ जमा करेगा और उसे लागू रखेगा:</p> <p>i) कार्य के निष्पादन से व्यक्ति या संपत्ति को हुये नुकसान से / दौरान होने वाली तीसरी पार्टी के नुकसान / उत्पन्न कोई भी दावा;</p> <p>ii) कार्य के निष्पादन के दौरान संविदाकार द्वारा नियोजित श्रमिकों को होने वाली हानि/क्षति से उत्पन्न होने वाला कोई भी दावा।</p> <p>iii) लागू पीएफ/श्रम कानूनों, ईएसआई, विनियमों आदि के गैर-अनुपालन के कारण कोई भी दावा।</p> <p>The Contractor shall indemnify and keep indemnified the RESERVE BANK OF INDIA against:</p>

	<p>i) Any claim arising out of third party loss/ damage to life or property caused by/during execution of the work.</p> <p>ii) Any claim arising out of loss/ damage to the workmen engaged by the contractor during execution of the work.</p> <p>iii) Any claim due to non-compliance of applicable PF/ Labour laws, ESI, regulations etc.</p>	
15	<p>संविदाकार को कार्य शुरू करने से पहले पहली पार्टी के रूप में भारतीय रिज़र्व बैंक के नाम पर सभी आवश्यक बीमा कवर अर्थात संविदाकार की सम्पूर्ण जोखिम पॉलिसी, श्रमिक क्षतिपूर्ति पॉलिसी, तृतीय पक्ष देयता आदि, जो भी लागू हो) लेना होगा।</p> <p>The contractor shall take necessary insurance covers (i.e. Contractor All Risk Policy, Workmen Compensation Policy, Third Party Liability etc as applicable) with Reserve Bank of India as the first name, at their cost, before commencement of the work.</p>	
	<p>यदि ठेकेदार एक भागीदारी या एक व्यक्ति है</p> <p>If the contractor is a Partnership or an Individual</p>	<p>इसके साक्ष्य में बैंक तथा ठेकेदार ने इन दस्तावेज़ों तथा मूल प्रति पर इसके ऊपर उल्लेखित दिन और वर्ष में हस्ताक्षर किए हैं।</p> <p>IN WITNESS WHEREOF The Bank and the Contractor have set their respective hands to these presents and two duplicates hereof the day and year first hereinabove written.</p>
	<p>यदि ठेकेदार एक कंपनी है</p> <p>If the contractor is a Company</p>	<p>इसके साक्ष्य में बैंक ने अपने विधिवत प्राधिकृत किये हैं और ठेकेदार ने इन पर तथा उक्त दोनों प्रतिलिपियों पर अपनी नियमित मोहर लगवाई है/इसके पहले उक्त दिनांक और वर्ष को अपनी ओर से इन दस्तावेज़ों तथा उक्त दो प्रतिलिपियों का निष्पादन करवाया है।</p> <p>IN WITNESS WHEREOF The Bank has set its hand to these presents through its duly authorized official and the Contractor has caused its common seal to be affixed hereunto and the said two duplicate/has caused these presents and the said two duplicates hereof to be executed on its behalf, the day and year first hereinabove written.</p>

## Signature Clause

SIGNED AND DELIVERED by the Reserve Bank of India by the hand of

Shri ..... (name and designation)

in the presence of

(1)

Address

(2)

## Address

<p>SIGNED AND DELIVERED BY</p> <p>.....</p> <p>.....</p> <p>(1)</p> <p>Address</p> <p>.....</p> <p>.....</p> <p>.....</p> <p>2)</p> <p>.....</p> <p>Address</p> <p>.....</p> <p>.....</p> <p>.....</p> <p>Witnesses</p>	<p>If the part is a partnership firm or any individual should be signed by all or on behalf of all the partners.</p>
<p>THE COMMON SEAL OF</p> <p>Was hereunto affixed pursuant to the resolutions passed</p> <p>By its Board of Directors at the meeting held on</p> <p>.....</p> <p>.....</p> <p>.....</p> <p>In the presence of</p> <p>( )</p> <p>.....</p> <p>( )</p> <p>.....</p> <p>Directors who have signed these presents in taken thereof in the presence of</p> <p>(1) .....</p> <p>....</p> <p>(2) .....</p> <p>....</p>	<p>If the Contractor signs under its common Seal the signature clause should tally with their sealing clause in the Articles of Associations.</p> <p>The Contractor is signing by the hand of power of attorney whether a company or individual.</p> <p>The Contractor is signing by the hand of power of attorney whether a company or individual.</p>

SIGNED AND DELIVERED BY the  
Contractor by the hand Of

Shri .....

and duly constituted attorney.



**Annexure III- Proforma of Bank Guarantee for Performance Security Deposit**  
*(On Non-Judicial Stamp Paper of appropriate value purchased in the name of the issuing Bank)*

Place:

Date:

The Regional Director  
Reserve Bank of India,  
Chandigarh

Dear Sir,

**Name of the work: Renovation of Cash Area for Installation of New SBS Machines at Main Office Building of Reserve Bank of India, Sector- 17A, Chandigarh**

**Bank Guarantee For PERFORMANCE SECURITY DEPOSIT/ Retention Money**

WHEREAS

Reserve Bank of India, Chandigarh having its Central Office at Shahid Bhagat Singh Road, Mumbai, (hereinafter called "the RBI") has awarded the Contract for the captioned project (hereinafter called the "Contract") to M/s \_\_\_\_\_ (Name of the Contractor) (hereinafter called "the said Contractor" which expression shall include its successors and assigns).

AND Whereas the Contractor is bound by the said Contract to submit to RBI a Performance Security for a total amount of ₹ \_\_\_\_\_ (Rupees \_\_\_\_\_ only) (Amount in figures and words) for the due fulfilment by the said contractor of the terms and conditions contained in the contract. We \_\_\_\_\_ Name of the Bank), (hereinafter called "the Bank"), at the request of M/s \_\_\_\_\_ the contractor, do hereby undertake to pay to the RBI an amount not exceeding ₹ \_\_\_\_\_ as Performance Guarantee for due fulfilment of the terms and conditions of the contract.

NOW THIS GUARANTEE WITNESSETH

1. We \_\_\_\_\_ (Name of the Bank) do hereby agree with and undertake to RBI, their Successors, Assigns that in the event of the RBI coming to the conclusion that the Contractor has not performed his obligations under the said conditions of the contract or have committed a breach thereof, which conclusion shall be binding on us as well as the said contractor; we shall on demand by the RBI, pay without demur to the RBI, a sum of ₹ \_\_\_\_\_ (Rupees \_\_\_\_\_ only) or any lower amount that may be demanded by the RBI. Our guarantee shall be treated as equivalent to the Performance Guarantee Amount for the due performance of the obligations of the Contractor under the said Contract, provided, however, that our liability against such sum shall not exceed the sum of ₹ \_\_\_\_\_ (Rupees \_\_\_\_\_ only).

2. We also agree to undertake to and confirm that the sum not exceeding ₹ \_\_\_\_\_ (Rupees \_\_\_\_\_ only) as aforesaid shall be paid by us without any demur or protest, merely on demand from the RBI on receipt of a notice in writing stating that the amount is due to them and we shall not ask for any further proof or evidence and the notice from the RBI shall be conclusive and binding on us and shall not be questioned by us in any respect or manner whatsoever. The Bank shall pay to RBI any money so demanded notwithstanding any dispute/disputes raised by the Contractor in any suit or proceedings pending before any Court, Tribunal or Arbitrator/s relating thereto and the liability under this guarantee shall be absolute and unequivocal. We

undertake to pay the amount claimed by the RBI within a period of one week from the date of receipt of the notice as aforesaid.

3. We confirm that our obligation to the RBI under this guarantee shall be independent of the agreement or agreements or other understandings between the RBI and the Contractor.

4. This guarantee shall not be revoked by us without prior consent in writing of the RBI.

We hereby further agree that –

a) Any forbearance or commission on the part of the RBI in enforcing the conditions of the said agreement or in compliance with any of the terms and conditions stipulated in the said Contract and/or hereunder or granting of any time or showing of any indulgence by the RBI to the Contractor or any other matters in connection therewith shall not discharge us in any way and our obligation under this guarantee. This guarantee shall be discharged only by the performance by the Contractor of their obligations and in the event of their failure to do so, by payment by us of the sum not exceeding ₹ \_\_\_\_\_ (Rupees \_\_\_\_\_ only).

b) Our liability under these presents shall not exceed the sum of ₹ \_\_\_\_\_ (Rupees \_\_\_\_\_ only).

c) Our liability under this agreement shall not be affected by any infirmity or irregularity on the part of our said constituents/clients or their obligations thereunder or by dissolution or change in the constitution of our said constituents.

d) This guarantee shall remain in force up to \_\_\_\_\_ (60 days beyond the Defect liability period) provided that if so desired by the RBI, this guarantee shall be renewed for a further period as may be indicated by them on the same terms and conditions as contained herein.

e) Our liability under these presents will terminate unless these presents are renewed as provided hereinabove on the \_\_\_\_\_ or on the day when our said constituents comply with their obligations, as to which a certificate in writing by the RBI alone is the conclusive proof whichever date is later. Unless a claim or suit or action is filed against us within \_\_\_\_\_ or any extended period, all the rights of the RBI against us under this guarantee shall be forfeited and we shall be released and discharged from all our obligations and liabilities hereunder.

In witness whereof I/We of the Bank have signed and sealed this guarantee on the \_\_\_\_\_ day of \_\_\_\_\_ (Month) (Year) being herewith duly authorized.

For and on behalf of \_\_\_\_\_ (Name of the Bank)

Signature of authorized Bank official

Name:

Designation

Stamp/ Seal of the Bank

Signed, sealed and delivered for and on behalf of the Bank by the above named in the presence of:

Witness 1

Signature .....

Name .....

Address .....

(NB: This guarantee will require stamp duty as applicable in the state, where it is executed and shall be signed by the official whose signature and authority shall be verified).

**Annexure IV- Undertaking regarding declaration of debarment by public institution(s)**  
*(To be submitted by the tenderer on their letterhead)*

**Name of work: Renovation of Cash Area for Installation of New SBS Machines at Main Office Building of Reserve Bank of India, Sector- 17A, Chandigarh**

1. I / We ..... (Name of the bidder) declares that

(a) I / We or nay of our allied firm\* is / are not debarred / suspended / blacklisted by any public institution / entity in India or any other country as on ..... (last date of submission of bid).

(b) I / We or any of our allied firm\* have not made any transgression in respect of the code of integrity (as mentioned in the tender) with any public institution / entity in India or any other country in last three years as on ..... (last date of submission of bid).

(c) I / We will inform the Bank in writing, in case, I / we or any of our allied firm\* is / are debarred / suspended / blacklisted by any public institution / entity in India or other country on or before award of work for the captioned work.

2. I / We ..... (Name of the bidder) declare that I /we or our allied firm\* ..... (Name of the allied firms(s)) is / are debarred / suspended / blacklisted by ..... (Name and address of public institution in India or any other country) and the same effective up to ..... (date). A copy of such letter is attached for your information and record.

(Seal and Signature of the bidder)

Date:

Place:

(Note: Strike out one of the above two declarations which is not applicable)

\*Allied firm: A firm would be termed as "allied firm" if the management is common, or substantial or majority shares are owned by the banned / suspended firm and by virtue of this it has a controlling voice. Further all successor firms will also be considered as allied firms.

**Annexure V- Proforma for Indemnifying the Employer against Contract Labour Rules / Regulations**

*(To be submitted by the successful tenderer on their letterhead)*

To,  
Regional Director,  
Reserve Bank of India  
Estate Department,  
Chandigarh– 160017

Madam / Dear Sir,

**Renovation of Cash Area for Installation of New SBS Machines at Main Office Building of Reserve Bank of India, Sector- 17A, Chandigarh**

We, M/s ..... (Name of contractor),  
hereby undertake that we shall comply with all the statutory rules/ regulations with regard to  
the employment of contract labour and their payment.

We also hereby fully indemnify and keep indemnified the Employer, i.e., Reserve Bank of India, against payments to be made to the contract labour and for the observance of the laws in this regard without prejudice to our right to claim indemnity from our sub-contractors.

Yours faithfully,

For \_\_\_\_\_

Authorised Signatory

Name and address of the Contractor:

Seal of the Contractor:

Date:

Place:

**Annexure VI- Proforma for Indemnifying the Employer against Patent Rights**  
(To be submitted by the successful tenderer on their letterhead)

To,

Regional Director,  
Reserve Bank of India  
Estate Department,  
Chandigarh – 160017

Madam / Dear Sir,

**Renovation of Cash Area for Installation of New SBS Machines at Main Office Building of Reserve Bank of India, Sector- 17A, Chandigarh**

We, M/s \_\_\_\_\_ (Name of Contractor) hereby undertake to fully indemnify and keep indemnified the Employer i.e. Reserve Bank of India against any action, claim or proceeding relating to infringement or use of any patent or design or any alleged patent or design rights and shall ourselves pay any royalties, license fees etc. which may be payable in respect of any article or part thereof included in the contract or damages, cost and charges of all and every sort that may be legally incurred in respect thereof.

In the event of any claims made under or action brought against Employer in respect of any such matters as aforesaid, we shall, on being notified thereof, at our own expense, settle any dispute or conduct any litigation that may arise therefrom, provided that we shall not be liable to indemnify the Employer if the infringement of the patent or design or any alleged patent or design right is the direct result of an order passed by the Engineer-in-Charge in this behalf.

Yours faithfully,

For \_\_\_\_\_

Authorised signatory

Name and address of the Contractor:

Seal of the Contractor:

Date:

Place:



भारतीय रिज़र्व बैंक  
संपदा विभाग  
चंडीगढ़

भारतीय रिज़र्व बैंक, सेक्टर-17ए चंडीगढ़ के मुख्य कार्यालय भवन में नई एसबीएस (SBS)  
मशीनों की स्थापना के लिए नकदी क्षेत्र के नवीनीकरण के कार्य  
हेतु ई-निविदा

**Tender for  
Renovation of Cash Area for Installation of New SBS Machines at Main Office  
Building of Reserve Bank of India, Sector- 17A, Chandigarh**

**RBI/Chandigarh Regional Office/Estate/9/24-25/ET/281**

**भाग- II (वित्तीय बोली)**

**Part II (Financial Bid)**

बोलीदाता का नाम : .....

पता: .....

दूरभाष सं: .....

ई-मेल: .....

बोली पूर्व बैठक का समय एवं स्थान	27 अगस्त 2024 पूर्वाह्न 11:00 बजे <b>स्थान:</b> संपदा विभाग, तृतीय तल, मुख्य कार्यालय भवन, भारतीय रिज़र्व बैंक, सेंट्रल विस्टा, सेक्टर-17, चंडीगढ़
बोली प्रस्तुत करने की अंतिम तिथि:	06 सितंबर 2024 को पूर्वाह्न 11:00 बजे तक
निविदा का भाग I अर्थात तकनीकी-वाणिज्यिक बोली खोलने की तिथि:	06 सितंबर 2024 को अपराह्न 03:00 बजे

<b>Estate Department</b>			
<b>Unpriced BOQ</b>			
<b>Renovation of Cash Area for Installation of New SBS Machines at Main Office Building of Reserve Bank of India, Sector-17A, Chandigarh</b> (Price Bid is to be submitted online on MSTC Portal only)			
<b>Name of the Firm:</b>			
<b>Sr. No.</b>	<b>Description of Items</b>	<b>Qty</b>	<b>UoM</b>
<b>1</b>	Dismantling of brickwork, doors, windows, aluminum partition, and disposal of debris unserviceable items to the designated authorized municipal dumping ground and stacking of unserviceable items to designated place. To understand the quantum of dismantling, existing layout and proposed layout is attached for assessment and reference.	1.00	LS
<b>2</b>	<b>Concrete Works:</b> Providing and laying in position cement concrete of 1:1½:3 (1 Cement: 1½ coarse sand (zone-III) derived from natural sources: 3 graded stone aggregate 20 mm nominal size derived from natural sources) excluding the cost of centering and shuttering as directed by Bank's Engineer:	11.06	CUM
<b>3</b>	<b>Brickwork:</b> Providing and constructing brick work with common burnt clay F.P.S. (non-modular) bricks of class designation 7.5 in substructure, foundation, plinth, superstructure etc. at any level, in Cement Mortar 1:4 (1 cement: 4 coarse sand). Rate shall be inclusive of working platform, racking of joints, curing, at all levels, etc. all complete as directed by Bank's Engineer.	22.80	CUM
<b>4</b>	<b>Half Brick Masonry :</b> Providing & constructing half brick work with common burnt clay F.P.S. (non-modular) bricks of class designation 7.5 in substructure, foundation and plinth, at any level, in Cement Mortar 1:4 (1 cement : 4 coarse sand) at all levels, using best quality locally available bricks including providing minimum 50 mm thick RCC band with 1:2:4 Grade concrete and using 2 nos. 8 mm dia TMT steel reinforcement at every fifth layer, making key with adjoining stone/brick masonry wall, as per site requirement including racking out joints, curing etc., all complete as directed by Bank's Engineer.	10.22	SQMT
<b>5</b>	<b>Kota Stone Flooring:</b> Providing & Fixing 25 mm thick Kota stone slab flooring over 20 mm (average) thick base laid over and jointed with grey cement slurry mixed with pigment to match the shade of the slab with base of cement mortar 1 : 4 (1 cement : 4 coarse sand) complete in all respect and as directed by Bank's Engineer:	390.71	SQMT
<b>6</b>	<b>Kota Stone Skirting:</b> Providing & Fixing Kota stone slabs 12 mm thick in skirting laid on 12 mm (average) thick cement mortar 1:3 (1 cement: 3 coarse sand) and jointed with grey cement slurry mixed with pigment to match the shade of the slabs, including rubbing and polishing complete in all respect and as directed by Bank's Engineer:	9.78	SQMT
<b>7</b>	Mirror polishing on marble work/Granite work/stone work where ever required to give high gloss finish/diamond/mirror finish for kota stone complete including removal of sludge, cleaning of area etc. complete.	400.49	SQMT



8	<p><b>ACP Wall Cladding:</b> Providing, fabricating and supplying and fixing Aluminium composite panel with frame on the walls of proposed Shredding Room with any of approved colour/shade/finish/pattern made out of 3.00 mm thick Aluminium composite panel material consisting of FR grade mineral core sandwiched between two Aluminium sheets (each 0.25mm thick). The Aluminium composite panel cladding sheet shall be PVDF / Lumiflon based fluoropolymer resin coating of approved colour and shade on face # 1 and polymer (Service) coating on face # 2 as specified using stainless steel screws, nuts, bolts, washers, cleats, sealing the joint with weatherproof silicone sealant, backer rods etc. all complete and as per the instruction of the Bank's Engineer.</p> <p>The main frame using shall consist of M10 X 100 SS anchor fastener, 100 x 50 x 50 x 6mm thick Aluminum Bracket on column, 50 mm X 25 mm Aluminium tube Aluminum rivets, 20mm X 20mm X 50mm X 2mm thick angle Aluminum cleat, M6 x 70mm S.S. nut bolt, EPDM gasket, weather silicon etc. The work also involves providing and fixing 'H' frame/ Bamboo scaffolding/Steel scaffolding for the cladding work with all safety arrangements including helmet, safety net and full body safety harness. All complete and as per the instruction of the Bank's Engineer. Bidder need to exercise his/her rates considering the wastage, labour for bending, cutting and fixing the ACP sheets.</p> <p>(Make: Euro Bond / Alto Bond/ Alu Decor/ Alutech/ Evabond/ Alucobond/ Alpolic or approved equivalent)</p> <p><b>Basic Rate of ACP Sheet= Rs. 1100/- per SqM Excluding GST</b></p>	135.32	SQMT
9	<p><b>PLASTERING:</b> Providing and applying average 15 mm cement plaster (on rough side of single or half brick wall) of mix CM 1:4 (1 Cement : 4 coarse Sand) to walls, columns, beams, etc., in line and level, curing of plaster etc., all complete as directed by Bank's Engineer.</p>	90.74	SQMT
10	<p><b>PLASTERING:</b> Providing and applying average 12mm thick (plumb side of wall) cement plaster in CM 1:4 (1 Cement : 4 coarse Sand) to walls, columns, beams, etc., in line and level, curing of plaster etc., all complete as directed by Bank's Engineer.</p>	90.74	SQMT
11	<p><b>PLASTERING:</b> Providing and applying average 6mm thick (Celing and soffit of beam) cement plaster in CM 1:3 (1 Cement : 3 coarse Sand) to Celing and soffit of beams, etc., in line and level, curing of plaster etc., all complete as directed by Bank's Engineer.</p>	390.71	SQMT
12	<p><b>REPAIRS TO LOOSE PLASTER in same patches up to 1.00 sqmt :</b> Dismantling of existing unsound loose plaster, disposal of debris and replaster the surface of the where plaster has been dismantled with thickness varying from 12-18mm (CM 1:3 (1 cement and 3 coarse sand) mixed with SBR based bonding agent of approved make. The work involves dismantling and replastering at height upto 25-30 feet. Vendor is strictly advised to assess the scope of work considering the height, material, labour, safety arrangement, scaffolding, and specially the small patches where replastering to be done all complete as directed by Bank's Engineer.</p>	15.70	SQMT

13	<b>Scraping and White Cement Based Putty:</b> Providing and applying white cement based putty of average thickness 1 mm, of approved brand and manufacturer, over the plastered wall surface to prepare the surface even and smooth complete. Rate inclusive of removing of existing finish by scrapping, removing the loose paint either with manual or mechanical means such as sand papering/chemical paint remover or electric paint stripper (wherever Required) including necessary repairs to scratches etc. complete.	1135.41	SQMT
14	<b>Emulsion paint:</b> Painting with two or more coats of acrylic emulsion paint, having VOC (Volatile Organic Compound) content less than 50 grams/ litre, of approved brand and manufacture, including applying primer and additional coats of paint wherever required, to achieve even shade and colour.	1135.41	SQMT
15	<b>Internal Painting with Synthetic Enamel paint over masonry/metal surface:</b> Providing and applying two or more coats of first quality synthetic enamel paint) of approved make/shade/finish to masonry/metal surface including application of one or more coat of cement primer & two or more coats of synthetic enamel paint over it. The rate shall also include repairs to plaster up to 0.10 Sqm. etc. as per the instructions of the Engineers of the Bank including necessary scaffolding. The prepared base surface shall be got approved from the Bank prior to the commencement of the painting.	100.00	SQMT
16	<b>SS (Grade 304) Railing:</b> Providing and fixing stainless steel (Grade 304) floor mounted bump rail made of Hollow tubes, channels, plates etc., including welding, grinding, buffing, polishing and making curvature (wherever required) and fitting the same with necessary stainless steel nuts and bolts complete, i/c fixing the railing with necessary accessories & stainless steel dash fasteners, stainless steel bolts etc., of required size, on the top of the floor or the side of waist slab with suitable arrangement as per approval of Bank's Engineer.  Note: For payment purpose, only weight of stainless steel members shall be considered excluding fixing accessories such as nuts, bolts, fasteners etc.	317.90	Kg

17	<p>Providing and fixing factory made <b>Single glass uPVC white colour casement glazed windows (variation of 50 mm in dimension given should be considered while quoting the rate)</b> comprising of uPVC multi-chambered frame, sash and mullion (where ever required) extruded profiles duly reinforced with <math>1.60 \pm 0.2</math> mm thick galvanized mild steel section made from roll forming process of required length (shape &amp; size according to uPVC profile), uPVC extruded glazing beads of appropriate dimension, <b>Single glass panes of 10 mm clear toughened glass</b>, EPDM gasket, <b>2 Nos Friction hinges</b> for each shutter/panels, zinc alloy (white powder coated) casement handles along with zinc plated mild steel multi point locking having transmission gear, cylinder with keeps and one side key, G.I fasteners 100 x 8 (minimum) mm size for fixing frame to finished wall, plastic packers, plastic caps and necessary stainless steel screws etc. Profile of frame &amp; sash shall be mitred cut and fusion welded at all corners, mullion (if required) shall be also fusion welded including drilling of holes for fixing hardware's and drainage of water etc. After fixing frame the gap between frame and adjacent finished masonry/structural elements shall be filled with weather proof silicon sealant over backer rod of required size and of approved quality, all complete as per approved drawing &amp; direction of Engineer-in-Charge. Variation in profile dimension in higher side shall be accepted but no extra payment on this account shall be made.</p> <p>Casement window made of 10 mm thick toughened glass, frame &amp; sash with <b>2 Nos Friction hinges</b> for each sash. Profile shall be made of frame of 60 x 60 mm &amp; sash / mullion 60 X 74 both having wall thickness of <math>2.3 \pm 0.2</math> mm and single glazing bead/ double glazing bead of appropriate dimension.</p> <p>For uPVC frame, sash and mullion extruded profiles minus 5% tolerance in dimension i.e. in depth &amp; width of profile shall be acceptable. Variation in profile dimension in higher side shall be accepted but no extra payment on this account shall be made.</p>	20.50	SQMT
----	---	-------	------

18	<p>Providing and fixing factory made uPVC white colour Casement glazed door comprising of uPVC multi-chambered frame, sash and mullion (where ever required) extruded profiles duly reinforced with <math>1.60 \pm 0.2</math> mm thick galvanized mild steel section made from roll forming process of required length (shape &amp; size according to uPVC profile), uPVC extruded glazing beads of appropriate dimension, Single glass panes of 12 mm clear toughened glass, EPDM gasket, zinc alloy (white powder coated) Minimum 4 Nos 3D Hinges for each shutter of the door and one handle on each side of panels along with zinc plated mild steel multi point locking having transmission gear, cylinder with keeps and one side key, G.I fasteners 100 x 8 mm size for fixing frame to finished wall and necessary stainless steel screws, etc. Profile of frame &amp; sash shall be mitred cut and fusion welded at all corners, mullion (if required) shall be also fusion welded including drilling of holes for fixing hardware's and drainage of water etc. Work also includes Providing, assembling 12.00 mm thick toughened glass for door glazing in UPVC door as per the technical specification of the tender After fixing frame the gap between frame and adjacent finished wall shall be filled with weather proof silicon sealant over backer rod of required size and of approved quality, all complete as per approved drawing &amp; direction of Engineer-in-Charge. Work should be complete in all respect in finished item of work including of supply of all materials, labor, sundries, taxes CPOH and no any other payment will be made for this work. Variation in profile dimension in higher side shall be accepted but no extra payment on this account shall be made. Variation in profile dimension in higher side shall be accepted but no extra payment on this account shall be made.</p> <p>Note: For uPVC frame, sash, mullion and transom at lock rail level extruded profiles minus 5% tolerance in dimension i.e. in depth &amp; width of profile shall be acceptable.</p> <p>Casement door made of 12.00 mm thick toughened glass, frame 67 x 64 mm &amp; sash 67 x 110 mm both having wall thickness of <math>2.3 \pm 0.2</math> mm, single glazing bead / double glazing bead of appropriate dimension. Minimum 4 Nos 3D Hinges for each shutter of the door.</p>	19.52	SQMT
19	<p>Providing and fixing factory made uPVC white colour <b>fixed louvered windows</b> comprising of uPVC multi-chambered frame, sash and mullion (where ever required) extruded profiles duly reinforced with <math>1.60 \pm 0.2</math> mm thick galvanized mild steel section made from roll forming process of required length (shape &amp; size according to uPVC profile), uPVC extruded glazing beads of appropriate dimension, uPVC premium quality louver of appropriate size equally spaced and fixed at uniform angle to hinder the visibility.</p>	3.00	SQMT
20	<p>Supply, Fabrication, Transportation, delivery at site and erection, installation and alignment of mild steel foundation mechanical anchor of size 20 X 150 mm for fixing of base plate as per the drawing. A base plate hole template shall be used to accurately install all anchor bolt assembly in concrete along with nuts, lock nuts, washers, tie rods including welding, cutting, grinding, threading, drilling, grouting under base plate etc. all complete as directed by Bank's Engineer.</p>	180.00	Nos

21	Supply and installation of Mild Steel Base plate (Size of the plate ranges between 300 x 300 mm to 600 X 600 mm) of approved thickness as per the drawing to be fixed over the Foundation bolts including welding, cutting, grinding, threading, drilling, with one coat of Red Oxide metal primer and two coat of Synthetic Enamel Paint etc. all complete as directed by Bank's Engineer. (94.2 kg/sqm) The Base plates shall be anchored to the existing Concrete flooring of the ramp with suitable anchor fasteners and rate quoted shall include the cost of all allied accessories, all complete as directed by Bank's Engineer. N.B.- 1. Nuts, Bolts, Washers, Stiffeners and other miscellaneous accessories will not be paid separately.	393.96	Kg
22	Providing and laying non-shrink grout (flowable) of M-60 Grade at the base plate (Fosroc make - Conbextra GP or approved equivalent)	0.21	CUM
23	Structural steel work riveted, bolted or welded in built up sections, trusses and framed work, including cutting, hoisting, fixing in position and applying one coat of Red Oxide metal primer and two coat of Synthetic Enamel Paint of approved steel primer and paint all complete all complete as directed by Bank's Engineer. The work also involves erecting scaffolding up to height of 5.00 meter from NGL/FFL which can be removed after completion of all the associated work under this item. N.B.- 1. Nuts, Bolts, Washers, Stiffeners and other miscellaneous accessories will not be paid separately.	658.54	Kg
24	Steel work in built up tubular section (round, square or rectangular hollow tubes etc.) including supplying, cutting, hoisting, fixing in position including welding and bolted with special shaped washers, one coat of Red Oxide metal primer and two coat of Synthetic Enamel Paint etc. all complete as directed by Bank's Engineer. The work also involves erecting scaffolding up to height of 5.00 meter from NGL/FFL which can be removed after completion of all the associated work under this item. N.B.- 1. Nuts, Bolts, Washers, Stiffeners and other miscellaneous accessories will not be paid separately.	1994.50	Kg
25	Fabrication, supply & erection of 6mm thick chequered plate at platform to required size and dimension & laying to correct alignment & level as directed by the Bank's Engineer and cutting necessary holes, trimming of edges and tack welding to kerb angle assembly as required at site. The rate quoted shall be inclusive of one coat of Red Oxide metal primer and two coat of Synthetic Enamel Paint all materials, labour, transportation, lead, lift, tools and plants, taxes etc. all complete. The work also involves erecting scaffolding up to height of 5.00 meter from NGL/FFL which can be removed after completion of all the associated work under this item. N.B.- 1. Nuts, Bolts, Washers, Stiffeners and other miscellaneous accessories will not be paid separately.	4275.68	Kg

26	<p>Providing and fixing polycarbonate multiple wall sheet roofing 10mm thick gauge of approved make UV coated of approved make and of approved colour and sealing the joints with aluminium extruded profile and gasket for fixing polycarbonate sheet using pressure plates with EPDM gasket (compatible to polycarbonate) breather tape, screws and covering the pressure plates complete and making the entire system water tight by using sealant as per architectural drawings and specification. The end shall also be sealed by using "C" type section. The work also involves erecting scaffolding up to height of 5.00 meter from NGL/FFL which can be removed after completion of all the associated work under this item.</p> <p>(Rate does not include cost of structural steel framing which will be paid separately)</p> <p>N.B.- 1. Nuts, Bolts, Washers, Stiffeners and other miscellaneous accessories will not be paid separately.</p>	83.51	SQMT
27	<p>Providing and fixing double scaffolding system (cup lock type) on the <b>interior side of building/structure</b>, upto 10 metre height, above FFL, including additional rows of scaffolding in stepped manner as per requirement of site, made with 40mm dia M.S. tube, placed 1.5 metre centre to centre, horizontal &amp; vertical tubes joint with cup &amp; lock system with M.S. Tubes, M.S. tube chalis, M.S. clamps and staircase system in the scaffolding for working platform etc. and maintaining it in a serviceable condition for execution of work of cleaning and/ or pointing and/ or applying chemical and removing it thereafter. The scaffolding system shall be stiffened with bracings, runners, connecting with the building etc., wherever required, if feasible, for inspection of work at required locations with essential safety features for the workmen etc., complete as per directions and approval of Engineer-in-charge.</p> <p>Note:-</p> <ol style="list-style-type: none"> <li>1) The elevational area (Height will be taken from FFL of the base floor to the top of the scaffolding) of the scaffolding shall be measured for payment purpose. For measurement purpose, maximum height will be taken from the floor/surface where scaffolding is supported; to the top of parapet (if scaffolding is continuous from floor/surface to top).</li> <li>2) The payment will be made once only for execution of all items for such works.</li> <li>3) The staging area of additional Tubular Frames for supporting double scaffolding system, if required shall not be measured for payment purpose.</li> <li>4) Suitable nylon of adequate strength nylon net around the working area of the building including curtain covering shall be fixed to catch any falling objects and for safety of workmen. No extra Payment will be made for P/F of Nylon Net and is including in this item of work.</li> <li>5) Scaffolding shall be measured once only and the same shall be maintained till the work is completed.</li> <li>6) All safety procedure while working on heights as per IS 3696 (Part-I)- 1987.</li> <li>7) Labors working on the scaffolding should be provided with safety belts, helmets and they should wear the same while working.</li> </ol>	235.87	SQMT